

Property Information

Property Names

Name Explanation	Name
Function/Location	House, 824 Page Street

Property Evaluation Status

Property Addresses

Current - 824 Page Street

County/Independent City(s):	Charlottesville (Ind. City)
Incorporated Town(s):	No Data
Zip Code(s):	22903
Magisterial District(s):	No Data
Tax Parcel(s):	No Data
USGS Quad(s):	CHARLOTTESVILLE EAST

Additional Property Information

Architecture Setting: Urban

Acreage: No Data

Site Description:

January 2020: This one-and-a-half-story house is located on the south side of Page Street, to the east of 9th Street NW. A chain link fence runs along the northeastern property line. The site is slightly sunken compared to the street level, and is accessed by a descending concrete step near the center of the northeastern property line. There are also chain link fences along the northwestern and southeastern property lines. Along the northwest elevation of the house, there is a concrete driveway with a carport. To the southwest of the carport, near the rear of the lot, there are two sheds. There is a tall bush near the center of the southeastern property line, and a large tree on the adjacent lot near the north corner. This property consists of a house, a carport, and two sheds.

Surveyor Assessment:

January 2020: According to the Charlottesville City Property Records, this house was constructed in 1925 (City of Charlottesville GIS Viewer 2020). This date is confirmed by Sanborn Maps. The 1929 and 1950 Sanborn Maps depict a rectangular, two-story dwelling with a partial-width, one-story front porch, and a partial-width, one-story rear porch, and a one-story outbuilding that is no longer extant (Sanborn Map Company 1920; Sanborn Map Company 1929; Sanborn Map Company 1950). Between 1994 and 2002, a large one-story addition was constructed on the rear of the house, replacing the earlier rear porch; and the current carport and two sheds were built (NETR 1994; NETR 2002). The front porch was expanded to full width at an unknown date.

This property retains good integrity of location and setting. The integrity of design, materials, and workmanship have been compromised by replacement cladding and windows; and the rear addition. This property retains good integrity of feeling and association. Overall, this property retains fair integrity.

This property is recommended as not individually eligible for listing in the NRHP due to a lack of historical significance. However, it is located in the potential 10th & Page Historic District, which is recommended as potentially eligible for listing in the NRHP. Further study is recommended to determine if the 10th & Page Historic District is eligible for listing in the NRHP under Criterion A in the areas of Ethnic Heritage, Community Planning and Development, and Social History, and under Criterion C in the area of Architecture. This property includes one contributing primary resource and three non-contributing secondary resources.

Surveyor Recommendation: Recommended Not Eligible

Ownership

Ownership Category	Ownership Entity
Private	No Data

Primary Resource Information

Resource Category:	Domestic
Resource Type:	Single Dwelling
NR Resource Type:	Building
Date of Construction:	1925
Date Source:	Local Records
Historic Time Period:	World War I to World War II (1917 - 1945)
Historic Context(s):	Domestic
Other ID Number:	No Data

Architectural Style: Vernacular
Form: *No Data*
Number of Stories: 1.5
Condition: Good
Threats to Resource: None Known

Architectural Description:

January 2020: This one-and-a-half-story house rests on a concrete foundation, is clad in aluminum siding, and has a front-gabled roof that is covered in asphalt shingles. There is a stuccoed chimney in the center of the ridgeline. The northeast-facing façade includes a one-story, full-width, screened-in porch with brick knee walls. The porch has a shed roof clad in asphalt shingles. The main entrance to this building is at the west end of the facade. On the southeast elevation, there is a secondary entrance surmounted by a shed roof metal awning. The rear (southwest) elevation includes two full-width, one-story, shed roof additions. The additions have a continuous roofline, but the cladding does not line up. According to aerial photographs, there is a rear porch on the southwest elevation of an unknown material (USGS 2016). All of the windows on the house have fixed wood shutters. Visible fenestration includes screened wood windows; one-over-one, double-hung, metal windows, some with screens; three-over-three, double-hung, wood windows with metal storm windows; a single-leaf wood door; a metal bar door and a metal and glass storm door.

Exterior Components

Component	Component Type	Material	Material Treatment
Chimneys	Interior Central	Unknown	Stuccoed/Parged
Foundation	Solid/Continuous	Concrete	Stuccoed/Parged
Porch	1-Story Full-Width	Wood	Square
Structural System and Exterior Treatment	Wood Frame	Aluminum	Siding
Windows	Double-hung	Vinyl	<i>No Data</i>
Roof	Front Gable	Asphalt	<i>No Data</i>

Secondary Resource Information

Secondary Resource #1

Resource Category: Domestic
Resource Type: Carport
NR Resource Type: Structure
Date of Construction: ca 2000
Date Source: Map
Historic Time Period: Post Cold War (1992 - Present)
Historic Context(s): Domestic
Other ID Number: *No Data*
Architectural Style: No discernible style
Form: *No Data*
Number of Stories: *No Data*
Condition: Good
Threats to Resource: None Known

Architectural Description:

January 2020: There is a carport located to the northwest of the house. It has a steel frame with a pointed arch rood that is covered with standing seam metal. The northwest side is clad in corrugated steel.

Secondary Resource #2

Resource Category: Domestic
Resource Type: Shed
NR Resource Type: Building
Date of Construction: ca 2000
Date Source: Map
Historic Time Period: Post Cold War (1992 - Present)
Historic Context(s): Domestic
Other ID Number: *No Data*
Architectural Style: No discernible style
Form: *No Data*

Number of Stories: 1.0
Condition: Good
Threats to Resource: None Known

Architectural Description:

January 2020: There is a one-story shed located to the southwest of the carport. This shed is clad in vinyl siding and has a front-gabled roof that is covered in asphalt shingles. Visible fenestration consists of a single-leaf door of unknown material; and a single-stall paneled wood overhead garage door (USGS 2016). However, based on siting, this building does not function as a garage, even though it looks like one and is labeled "Kenney Garage."

Exterior Components

Component	Component Type	Material	Material Treatment
Structural System and Exterior Treatment	Wood Frame	Vinyl	Siding
Roof	Front Gable	Asphalt	No Data

Secondary Resource #3

Resource Category: Domestic
Resource Type: Shed
NR Resource Type: Building
Date of Construction: ca 2000
Date Source: Map
Historic Time Period: Post Cold War (1992 - Present)
Historic Context(s): Domestic
Other ID Number: No Data
Architectural Style: No discernible style
Form: No Data
Number of Stories: 1.0
Condition: Good
Threats to Resource: None Known

Architectural Description:

January 2020: This one-story shed is located directly northwest of the first shed. It is clad in plywood and has a side gable roof that is covered with asphalt shingles. Visible fenestration consists of a single-leaf door of unknown material (USGS 2016).

Exterior Components

Component	Component Type	Material	Material Treatment
Structural System and Exterior Treatment	Wood Frame	Plywood/Particle Board	Panels
Roof	Side Gable	Asphalt	No Data

Historic District Information

Historic District Name: No Data
Local Historic District Name: No Data
Historic District Significance: No Data

CRM Events

Event Type: Survey:Phase I/Reconnaissance

Project Review File Number: No Data
Investigator: Erin Que
Organization/Company: The 106 Group Ltd.
Photographic Media: Digital
Survey Date: 2/5/2020
Dhr Library Report Number: No Data

Project Staff/Notes:

Erin Que, Principal Investigator and Sr. Architectural Historian
Holly Good, Architectural Historian
Saleh Miller, Sr. Architectural Historian

Project Bibliographic Information:

City of Charlottesville GIS Viewer
2020 Property Record. Electronic document, <http://gisweb.charlottesville.org/GisViewer/>, accessed January 27, 2020.

Hill Directory Co.
1931, 1940, 1950, 1959 Hill's Charlottesville City Directory. Hill Directory Co., Inc., Publishers, Richmond, Virginia.

National Environmental Title Research, LLC [NETR]
1963-2016 Historical Aerial Photograph, Charlottesville Independent City, Virginia. Electronic document, <http://historicaerials.com/>, accessed March 19, 2020.

Neighborhood Development Services
2012-2016 The 10th and Page Historic Survey. On file at the City of Charlottesville Neighborhood Development Services, Charlottesville, Virginia.

Sanborn Map Company
1907, 1913, 1920, 1929, 1950 Fire Insurance Map of Charlottesville, Virginia. Sanborn Map Company, New York, New York.

United States Geological Survey [USGS]
1994-2019 Historical Aerial Photograph, Charlottesville Independent City, Virginia. Electronic document, accessed on Google Earth, February 20, 2020.

Bibliographic Information

Bibliography:

No Data

Property Notes:

No Data

PAGE ST

DRIVEWAY

CARPORT

SHED 1

SHED 2

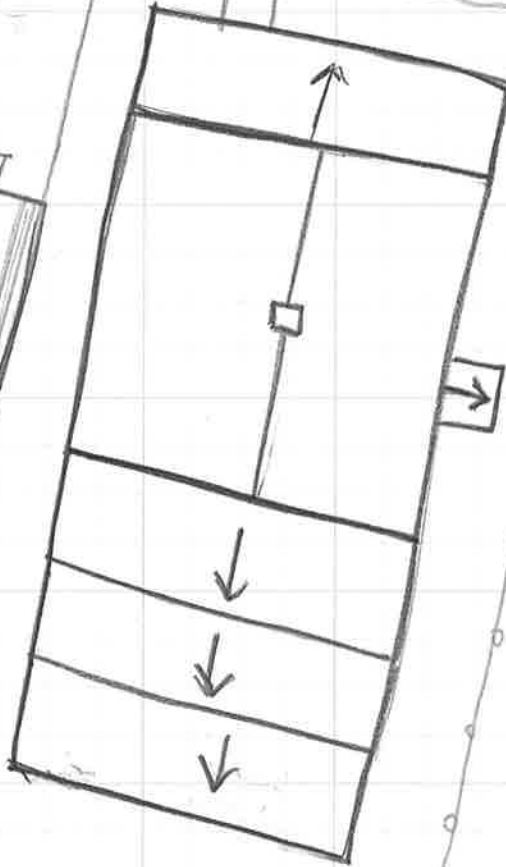

TN
House
104-5875
824 Page St
Survey Date 1/30/20
Not to Scale