

Property Information

Property Names

Name Explanation	Name
Function/Location	House, 904 Page Street

Property Evaluation Status

Property Addresses

Current - 904 Page Street

County/Independent City(s):	Charlottesville (Ind. City)
Incorporated Town(s):	No Data
Zip Code(s):	22903
Magisterial District(s):	No Data
Tax Parcel(s):	No Data
USGS Quad(s):	CHARLOTTESVILLE EAST

Additional Property Information

Architecture Setting: Urban

Acres: No Data

Site Description:

January 2020: This two-story house is located on the north side of Page Street, east of Hardy Drive. It has a wood picket fence surrounding the property. Along the southwest property line, the fence is supported by a concrete block retaining wall. In the middle of the wall, there are two concrete steps that lead to a wood gate and a slate sidewalk that leads to the house. Along the southeast property line, there is an asphalt driveway. There is a large tree near the west corner of the house. There is a shed near the north corner of the lot. There are several tall trees and neighboring parcels along the northeast and northwest property lines. This property consists of a house and a shed.

Surveyor Assessment:

January 2020: According to the Charlottesville City Property Records, this house was constructed in 1925 (City of Charlottesville GIS Viewer 2020). This house first appears on the 1929 Sanborn Maps as a two-story rectangular dwelling with a one-story, open front porch, three one-story wings on the rear that form an L, and an L-shaped open porch in the corner of the L. The footprint remained unchanged in 1950 (Sanborn Map Company 1929; Sanborn Map Company 1950). Prior to 1968, a second story was added to two of the rear wings and the remaining wing and porch were converted into an almost full-width, open rear porch (NETR 1968). The shed was built between 2009 and 2013 (City of Charlottesville GIS Viewer 2020). This property has been owned by Sallie T. Chisholm Wilson Robinson since 1977, along with 903 Page Street; she passed away in 2015. She was likely related to the Chisholm family who long-owned 900 Page Street across the street (City of Charlottesville GIS Viewer 2020; Daily Progress 2015).

This property retains good integrity of location and setting. The integrity of design, materials, and workmanship have been slightly compromised by replacement windows and siding. This property retains good integrity of feeling and association. Overall, this property retains good integrity.

This property is recommended as not individually eligible for listing in the NRHP due to a lack of historical significance. However, it is located in the potential 10th & Page Historic District, which is recommended as potentially eligible for listing in the NRHP. Further study is recommended to determine if the 10th & Page Historic District is eligible for listing in the NRHP under Criterion A in the areas of Ethnic Heritage, Community Planning and Development, and Social History, and under Criterion C in the area of Architecture. This property includes one contributing primary resource and one non-contributing secondary resource.

Surveyor Recommendation: Recommended Not Eligible

Ownership

Ownership Category	Ownership Entity
Private	No Data

Primary Resource Information

Resource Category:	Domestic
Resource Type:	Single Dwelling
NR Resource Type:	Building
Date of Construction:	1925
Date Source:	Local Records
Historic Time Period:	World War I to World War II (1917 - 1945)

Historic Context(s): Domestic
Other ID Number: *No Data*
Architectural Style: Vernacular
Form: *No Data*
Number of Stories: 2.0
Condition: Good
Threats to Resource: None Known

Architectural Description:

January 2020: This two-story house rests on a concrete foundation, is clad in vinyl siding, and has a hip-on-hip roof with a shed roof in the north corner; the roof is covered in asphalt shingles. The southwest-facing facade features a half-width, one-story, open porch with a hipped roof supported by metal filigree columns with metal railings. This porch sits on a concrete block foundation and is accessed by concrete steps with metal railings. There is a one-story, half-width partially open porch on the northeast elevation. The porch has a shed roof according to aerial photographs (USGS 2016). Visible fenestration includes six-over-six, double-hung, vinyl windows; one-over-one, double-hung, vinyl windows, some with screens; a vinyl picture window flanked by two-over-two, double-hung, vinyl windows; a single leaf wood door with a fanlight and a metal, glass, and screened storm door.

Exterior Components

Component	Component Type	Material	Material Treatment
Foundation	Solid/Continuous	Concrete	Stuccoed/Parged
Porch	1-Story Partial Width	Metal	Cast Metal Supports
Structural System and Exterior Treatment	Wood Frame	Vinyl	Siding
Windows	Double-hung	Vinyl	<i>No Data</i>
Roof	Hipped	Asphalt	<i>No Data</i>

Secondary Resource Information

Secondary Resource #1

Resource Category: Domestic
Resource Type: Shed
NR Resource Type: Building
Date of Construction: ca 2013
Date Source: Map
Historic Time Period: Post Cold War (1992 - Present)
Historic Context(s): Domestic
Other ID Number: *No Data*
Architectural Style: No discernible style
Form: *No Data*
Number of Stories: 1.0
Condition: Excellent
Threats to Resource: None Known

Architectural Description:

January 2020: There is a one-story shed at the end of the asphalt driveway, to the north of the house. It is clad in vinyl siding and has a front gable roof that is covered with asphalt shingles. Visible fenestration consists of a single-leaf wood door.

Exterior Components

Component	Component Type	Material	Material Treatment
Structural System and Exterior Treatment	Wood Frame	Vinyl	Siding
Roof	Front Gable	Asphalt	<i>No Data</i>

Historic District Information

Historic District Name: *No Data*
Local Historic District Name: *No Data*
Historic District Significance: *No Data*

CRM Events

Event Type: Survey:Phase I/Reconnaissance

Project Review File Number: *No Data*
Investigator: Erin Que
Organization/Company: The 106 Group Ltd.
Photographic Media: Digital
Survey Date: 2/5/2020
Dhr Library Report Number: *No Data*

Project Staff/Notes:

Erin Que, Principal Investigator and Sr. Architectural Historian
Holly Good, Architectural Historian
Saleh Miller, Sr. Architectural Historian

Project Bibliographic Information:

City of Charlottesville GIS Viewer
2020 Property Record. Electronic document, <http://gisweb.charlottesville.org/GisViewer/>, accessed January 27, 2020.

Hill Directory Co.
1931, 1940, 1950, 1959 Hill's Charlottesville City Directory. Hill Directory Co., Inc., Publishers, Richmond, Virginia.

National Environmental Title Research, LLC [NETR]
1963-2016 Historical Aerial Photograph, Charlottesville Independent City, Virginia. Electronic document, <http://historicaerials.com/>, accessed March 19, 2020.

Neighborhood Development Services
2012-2016 The 10th and Page Historic Survey. On file at the City of Charlottesville Neighborhood Development Services, Charlottesville, Virginia.

Sanborn Map Company
1907, 1913, 1920, 1929, 1950 Fire Insurance Map of Charlottesville, Virginia. Sanborn Map Company, New York, New York.

United States Geological Survey [USGS]
1994-2019 Historical Aerial Photograph, Charlottesville Independent City, Virginia. Electronic document, accessed on Google Earth, February 20, 2020.

Bibliographic Information

Bibliography:

Daily Progress
2015 Obituary: Sallie T. Chisholm Wilson Robinson. Electronic document, https://www.dailyprogress.com/obituaries/robinson-sallie-t-chisholm-wilson/article_76d391bf-b2fa-51cb-b94b-0bb90afcbf1e.html, accessed March 24, 2020.

Property Notes:

No Data

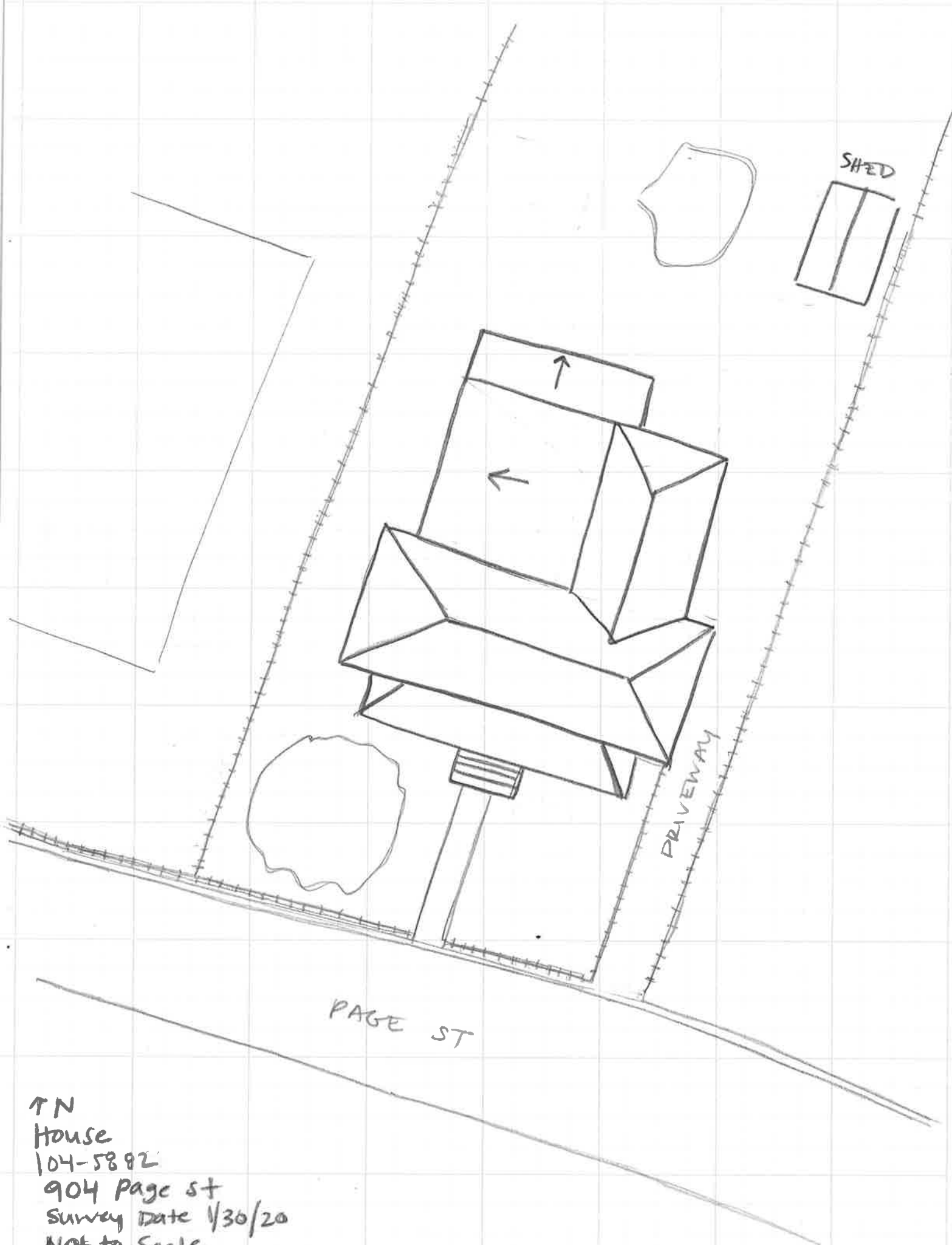

↑ N
House
104-5882
904 Page St
Survey Date 1/30/20
Not to Scale