

Property Information

Property Names

Name Explanation Function/Location	Name House, 923 Page Street
--	---------------------------------------

Property Evaluation Status

Property Addresses

Current - 923 Page Street

County/Independent City(s):	Charlottesville (Ind. City)
Incorporated Town(s):	No Data
Zip Code(s):	22903
Magisterial District(s):	No Data
Tax Parcel(s):	No Data
USGS Quad(s):	CHARLOTTESVILLE EAST

Additional Property Information

Architecture Setting: Urban

Acreage: No Data

Site Description:

January 2020: This one-story house is located on the north side of Page Street, just east of 10th Street NW. It is set far back in the lot. The front yard has a large tree in the west half and smaller bushes in the east half. There is a short picket fence along the northwest property line that connects to a taller wood fence. There is also a short concrete block wall along the southwest and southeast property lines. The shed associated with 922 Morton Lane is sited very close to this house's north corner. This property consists of a house.

Surveyor Assessment:

January 2020: According to the Charlottesville City Property Records, this house was constructed in 1941 (City of Charlottesville GIS Viewer 2020). The house is depicted on the 1950 Sanborn Maps as a one-story, rectangular-shaped dwelling with a half-width front porch and a half-width rear porch. It is identified as both 922 and 923 Page Street, with the property to the north identified as 912 1/2 Page (now 920 Morton Lane) (Sanborn Map Company 1950). Sometime before 1994, the rear porch was extended to full-width and enclosed (NETR 1994). Frank Page lived here in the 1950s and the property has been in the Morrison family since 1986; the property at 920 Page Street is also in the Morrison family (City of Charlottesville GIS Viewer 2020; Hill Directory Co. 1950; Hill Directory Co. 1959).

This property retains good integrity of location. The integrity of setting has been compromised by the construction of the neighboring house to the west in 2005 (City of Charlottesville GIS Viewer 2020). The integrity of design, materials, and workmanship have been compromised by the addition of the metal awning to the front porch and the enclosure and extension of the rear porch. This property retains good integrity of feeling and association. Overall, this property retains good integrity.

This property is recommended as not individually eligible for listing in the NRHP due to a lack of historical significance. However, it is located in the potential 10th & Page Historic District, which is recommended as potentially eligible for listing in the NRHP. Further study is recommended to determine if the 10th & Page Historic District is eligible for listing in the NRHP under Criterion A in the areas of Ethnic Heritage, Community Planning and Development, and Social History, and under Criterion C in the area of Architecture. This property includes one contributing primary resource.

Surveyor Recommendation: Recommended Not Eligible

Ownership

Ownership Category Private	Ownership Entity No Data
--------------------------------------	------------------------------------

Primary Resource Information

Resource Category:	Domestic
Resource Type:	Single Dwelling
NR Resource Type:	Building
Date of Construction:	1941
Date Source:	Local Records
Historic Time Period:	World War I to World War II (1917 - 1945)
Historic Context(s):	Domestic
Other ID Number:	No Data

Architectural Style: Minimal Traditional
Form: *No Data*
Number of Stories: 1.0
Condition: Good
Threats to Resource: None Known

Architectural Description:

January 2020: This one-story house rests on a concrete foundation, is clad in stucco, and has a front-gabled roof that is covered in standing seam metal. There is an interior brick chimney on the southeast roof slope on the northwest roof slope. The southwest-facing facade features a partial-width, one-story, open porch with a shed roof covered in standing seam metal. This porch is supported by square wood columns with metal railings. The porch is accessed by concrete stairs with metal railings, and there is wood latticework beneath the porch. On all sides of the porch, there is also a ribbed metal shed roof awning. The main entrance for the house is near the center of the facade. The rear (northeast) elevation features a full-width, shed roof wing that is also clad in stucco. Visible fenestration includes a single-leaf wood door with a metal and glass storm door; one-over-one, double-hung, metal windows with metal storm windows and screens.

Exterior Components

Component	Component Type	Material	Material Treatment
Chimneys	Interior Slope	Brick	Stretcher Bond
Foundation	Solid/Continuous	Concrete	Stuccoed/Parged
Porch	1-Story Partial Width	Wood	Posts
Structural System and Exterior Treatment	Not Visible	Unknown	Stuccoed
Windows	Double-hung	Metal	<i>No Data</i>
Roof	Front Gable	Metal	<i>No Data</i>

Secondary Resource Information

Historic District Information

Historic District Name: *No Data*
Local Historic District Name: *No Data*
Historic District Significance: *No Data*

CRM Events

Event Type: Survey:Phase I/Reconnaissance

Project Review File Number: *No Data*
Investigator: Erin Que
Organization/Company: The 106 Group Ltd.
Photographic Media: Digital
Survey Date: 2/5/2020
Dhr Library Report Number: *No Data*

Project Staff/Notes:

Erin Que, Principal Investigator and Sr. Architectural Historian
 Holly Good, Architectural Historian
 Saleh Miller, Sr. Architectural Historian

Project Bibliographic Information:

City of Charlottesville GIS Viewer
 2020 Property Record. Electronic document, <http://gisweb.charlottesville.org/GisViewer/>, accessed January 27, 2020.

Hill Directory Co.
 1931, 1940, 1950, 1959 Hill's Charlottesville City Directory. Hill Directory Co., Inc., Publishers, Richmond, Virginia.

National Environmental Title Research, LLC [NETR]
 1963-2016 Historical Aerial Photograph, Charlottesville Independent City, Virginia. Electronic document, <http://historicaerials.com/>, accessed March 19, 2020.

Neighborhood Development Services
2012-2016 The 10th and Page Historic Survey. On file at the City of Charlottesville Neighborhood Development Services, Charlottesville, Virginia.

Sanborn Map Company
1907, 1913, 1920, 1929, 1950 Fire Insurance Map of Charlottesville, Virginia. Sanborn Map Company, New York, New York.

United States Geological Survey [USGS]
1994-2019 Historical Aerial Photograph, Charlottesville Independent City, Virginia. Electronic document, accessed on Google Earth, February 20, 2020.

Bibliographic Information

Bibliography:

No Data

Property Notes:

No Data

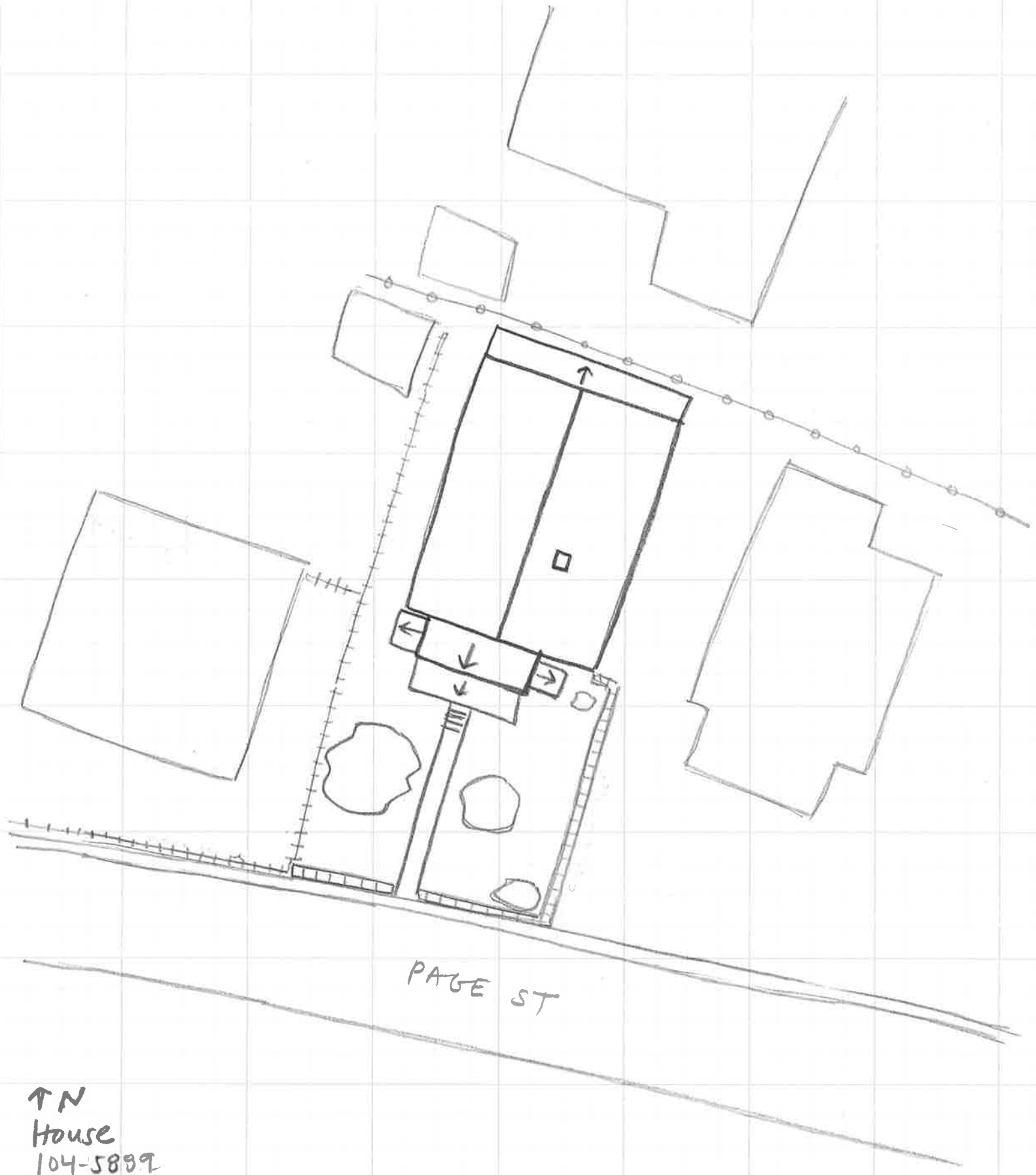

PAGE ST

↑ N
House
104-5899
923 page st
Survey Date 1/30/20
Not to Scale