

Property Information

Property Names

| | |
|--|---------------------------------------|
| Name Explanation Function/Location | Name House, 702 West Street |
|--|---------------------------------------|

Property Evaluation Status

Property Addresses

Current - 702 West Street

| | |
|------------------------------------|-----------------------------|
| County/Independent City(s): | Charlottesville (Ind. City) |
| Incorporated Town(s): | <i>No Data</i> |
| Zip Code(s): | 22903 |
| Magisterial District(s): | <i>No Data</i> |
| Tax Parcel(s): | <i>No Data</i> |
| USGS Quad(s): | CHARLOTTESVILLE EAST |

Additional Property Information

Architecture Setting: Urban

Acreage: *No Data*

Site Description:

January 2020: This one-story house is located on the south side of West Street. There is a two-story, multi-family, secondary dwelling to the southwest of this house, and a small parking pad to the northeast of the house. There are small box hedges dotted throughout the property. This property consists of a house and a secondary duplex dwelling.

Surveyor Assessment:

January 2020: According to the City of Charlottesville Property Records, this house was constructed in 1958 (City of Charlottesville GIS Viewer 2020). This is supported by the fact that both buildings are absent in the 1950 Sanborn Map, but are both seen in 1963 aerials, suggesting they were built contemporaneously (Sanborn Map Company 1950; NETR 1963; USGS 1994).

This property retains excellent integrity of location and setting. The integrity of design, materials, and workmanship is minimally compromised by replacement windows and doors. This property retains excellent integrity of feeling and association. Overall, this property retains good integrity.

This property is recommended as not individually eligible for listing in the NRHP due to a lack of historical significance. However, it is located in the potential 10th & Page Historic District, which is recommended as potentially eligible for listing in the NRHP. Further study is recommended to determine if the 10th & Page Historic District is eligible for listing in the NRHP under Criterion A in the areas of Ethnic Heritage, Community Planning and Development, and Social History, and under Criterion C in the area of Architecture. This property includes one contributing primary resource and one contributing secondary resource.

Surveyor Recommendation: Recommended Not Eligible

Ownership

| | |
|--------------------------------------|---|
| Ownership Category Private | Ownership Entity <i>No Data</i> |
|--------------------------------------|---|

Primary Resource Information

| | |
|------------------------------|--------------------------------|
| Resource Category: | Domestic |
| Resource Type: | Single Dwelling |
| NR Resource Type: | Building |
| Date of Construction: | 1958 |
| Date Source: | Local Records |
| Historic Time Period: | The New Dominion (1946 - 1991) |
| Historic Context(s): | Domestic |
| Other ID Number: | <i>No Data</i> |
| Architectural Style: | Minimal Traditional |
| Form: | <i>No Data</i> |
| Number of Stories: | 1.0 |
| Condition: | Good |

Threats to Resource: None Known

Architectural Description:

January 2020: This one-story house sits on a concrete block foundation, is constructed of concrete block, and has a front-gabled roof covered in asphalt shingles. The front (northeast) facing façade features a partial-width, one-story, open porch with a front-gabled roof. The gable end is clad in vinyl siding. The porch roof is supported by turned wood columns and the porch is accessed by concrete steps. The main entrance for this house is in the center of this facade. There is another small, one-story porch on the rear (southwest) facing elevation with a shed roof, covering a secondary entrance. Visible fenestration includes glass block windows; one-over-one, double-hung, vinyl windows; and a single-leaf, wood door with a metal and glass storm door.

Exterior Components

| Component | Component Type | Material | Material Treatment |
|--|-----------------------|----------|--------------------|
| Foundation | Solid/Continuous | Concrete | Block |
| Porch | 1-Story Partial Width | Wood | Turned |
| Structural System and Exterior Treatment | Masonry | Concrete | Block |
| Windows | Double-hung | Vinyl | No Data |
| Roof | Front Gable | Asphalt | No Data |

Secondary Resource Information

Secondary Resource #1

Resource Category: Domestic
Resource Type: Double/Duplex
NR Resource Type: Building
Date of Construction: 1958
Date Source: Local Records
Historic Time Period: The New Dominion (1946 - 1991)
Historic Context(s): Domestic
Other ID Number: No Data
Architectural Style: Vernacular
Form: No Data
Number of Stories: 2.0
Condition: Good
Threats to Resource: None Known

Architectural Description:

January 2020: There is a two-story, duplex, secondary dwelling to the southwest of the house. This dwelling is constructed of concrete block and has a side-gabled roof covered in asphalt shingles. The dwelling is accessed via concrete steps beneath a metal shed-roof awning. Visible fenestration includes one-over-one, double-hung, vinyl windows; one-by-one, sliding, vinyl windows; and a single-leaf wood door with a metal and glass storm door.

Exterior Components

| Component | Component Type | Material | Material Treatment |
|--|-----------------|----------|--------------------|
| Porch | Overhang/Awning | Metal | Not Visible |
| Structural System and Exterior Treatment | Masonry | Concrete | Block |
| Windows | Double-hung | Vinyl | No Data |
| Roof | Side Gable | Asphalt | No Data |

Historic District Information

Historic District Name: No Data
Local Historic District Name: No Data
Historic District Significance: No Data

CRM Events

Event Type: Survey:Phase I/Reconnaissance

Project Review File Number: *No Data*
Investigator: Erin Que
Organization/Company: The 106 Group Ltd.
Photographic Media: Digital
Survey Date: 2/5/2020
Dhr Library Report Number: *No Data*

Project Staff/Notes:

Erin Que, Principal Investigator and Sr. Architectural Historian
Holly Good, Architectural Historian
Saleh Miller, Sr. Architectural Historian

Project Bibliographic Information:

City of Charlottesville GIS Viewer
2020 Property Record. Electronic document, <http://gisweb.charlottesville.org/GisViewer/>, accessed January 27, 2020.

Hill Directory Co.
1931, 1940, 1950, 1959 Hill's Charlottesville City Directory. Hill Directory Co., Inc., Publishers, Richmond, Virginia.

National Environmental Title Research, LLC [NETR]
1963-2016 Historical Aerial Photograph, Charlottesville Independent City, Virginia. Electronic document, <http://historicaerials.com/>, accessed March 19, 2020.

Neighborhood Development Services
2012-2016 The 10th and Page Historic Survey. On file at the City of Charlottesville Neighborhood Development Services, Charlottesville, Virginia.

Sanborn Map Company
1907, 1913, 1920, 1929, 1950 Fire Insurance Map of Charlottesville, Virginia. Sanborn Map Company, New York, New York.

United States Geological Survey [USGS]
1994-2019 Historical Aerial Photograph, Charlottesville Independent City, Virginia. Electronic document, accessed on Google Earth, February 20, 2020.

Bibliographic Information

Bibliography:

No Data

Property Notes:

No Data

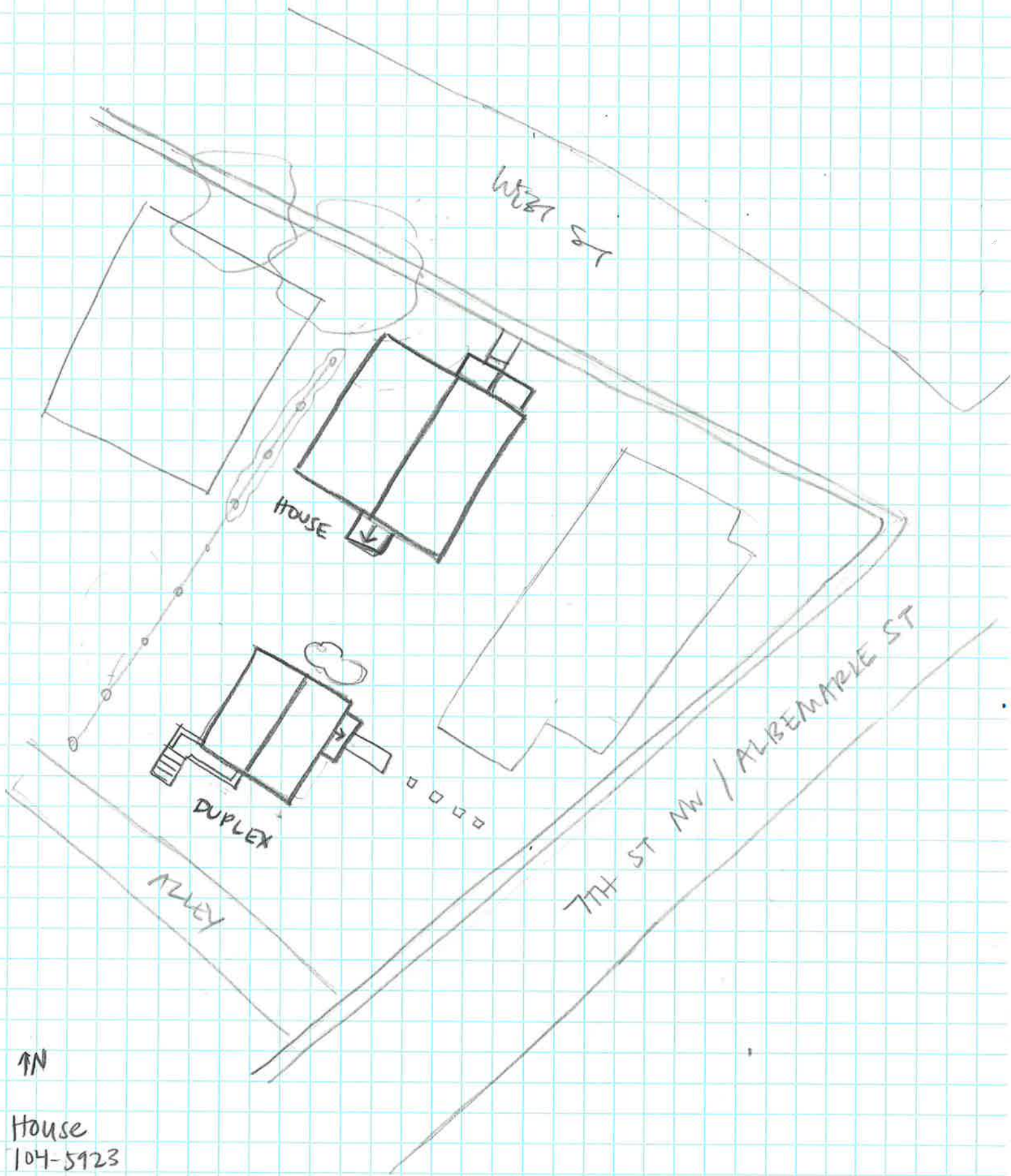

House

104-5923

702 WEST ST

SURVEY DATE 2/3/2020

NOT TO SCALE