

From: Scala, Mary Joy
Sent: Friday, December 09, 2011 7:58 AM
To: Will Teass (will@TEKTONICS.COM)
Cc: Grady Lewis (aglewis3rd@hotmail.com)
Subject: BAR Action - 600 preston Place

December 9, 2011

Tektonics Design group, c/o Will Teass
515 M Street SE, Suite 116
Washington, DC 20003

Preliminary Discussion

BAR 11-09-08
600 Preston Place
Tax Map 5 Parcel 109
Will Teass, AIA, Applicant/ Xi Chapter of Theta Chi Alumni Corp, Owner
Enlarge fraternity with three-level addition for five additional bedrooms

Dear Applicant,

The above referenced project was discussed before a meeting of the City of Charlottesville Board of Architectural review (BAR) on November 15, 2011.

The following action was taken:

The BAR held a preliminary discussion and made suggestions. In general they continued to be supportive of the project.

Some comments made include: Maples or Oaks may be better choices than Lindens; beef up the screening from Grady at the terrace area; simplify landscaped areas; need dense and architectural landscaping, not Nandinas; move bike racks behind screen wall; re-work belt course/plinth design; make guardrail more deferential to architecture; address relationship of windows; bring down terrace; avoid guardrails on old porch; use site details to knit project back into residential community; don't introduce institutional feel. The full discussion may be found in the archived video here: http://charlottesville.granicus.com/ViewPublisher.php?view_id=2

If you have any questions, please contact me at 434-970-3130 or scala@charlottesville.org.

Sincerely yours,

Mary Joy Scala, AICP
Preservation and Design Planner
Mary Joy Scala, AICP
Preservation and Design Planner
City of Charlottesville
Department of Neighborhood Development Services
City Hall - 610 East Market Street
P.O. Box 911
Charlottesville, VA 22902
Ph 434.970.3130 FAX 434.970.3359
scala@charlottesville.org

Transmittal:

Date: 27 October 2011
To: Mary Joy Scala
Charlottesville Department of Neighborhood Services
605 E. Main St
Charlottesville, VA 22902
Phone Number: (434) 970-3130
VIA Courier
Project: Theta Chi / 600 Preston Place | D11209
From: Will Teass, AIA
CC: Grady Lewis, Jim Johnston

Thank you so much for your understanding and help with this issue. We are returning the following documents for your review:

- 1 10 copies of BAR Final Submission (corrected page 19 / A3.02)

Please contact me at (202) 683-6260 x201 with any questions or comments.

Transmittal:

Date: 25 October 2011
To: Mary Joy Scala
Charlottesville Department of Neighborhood Services
605 E. Main St
Charlottesville, VA 22902
Phone Number: (434) 970-3130
VIA Courier
Project: Theta Chi / 600 Preston Place | D11209
From: Will Teass, AIA
CC: Grady Lewis, Jim Johnston

We are sending the following documents for your review:

- 1 10 copies of BAR Final Submission

Please contact me at (202) 683-6260 x201 with any questions or comments.

RECEIVED
OCT 25 2011
NEIGHBORHOOD DEVELOPMENT SERVICES

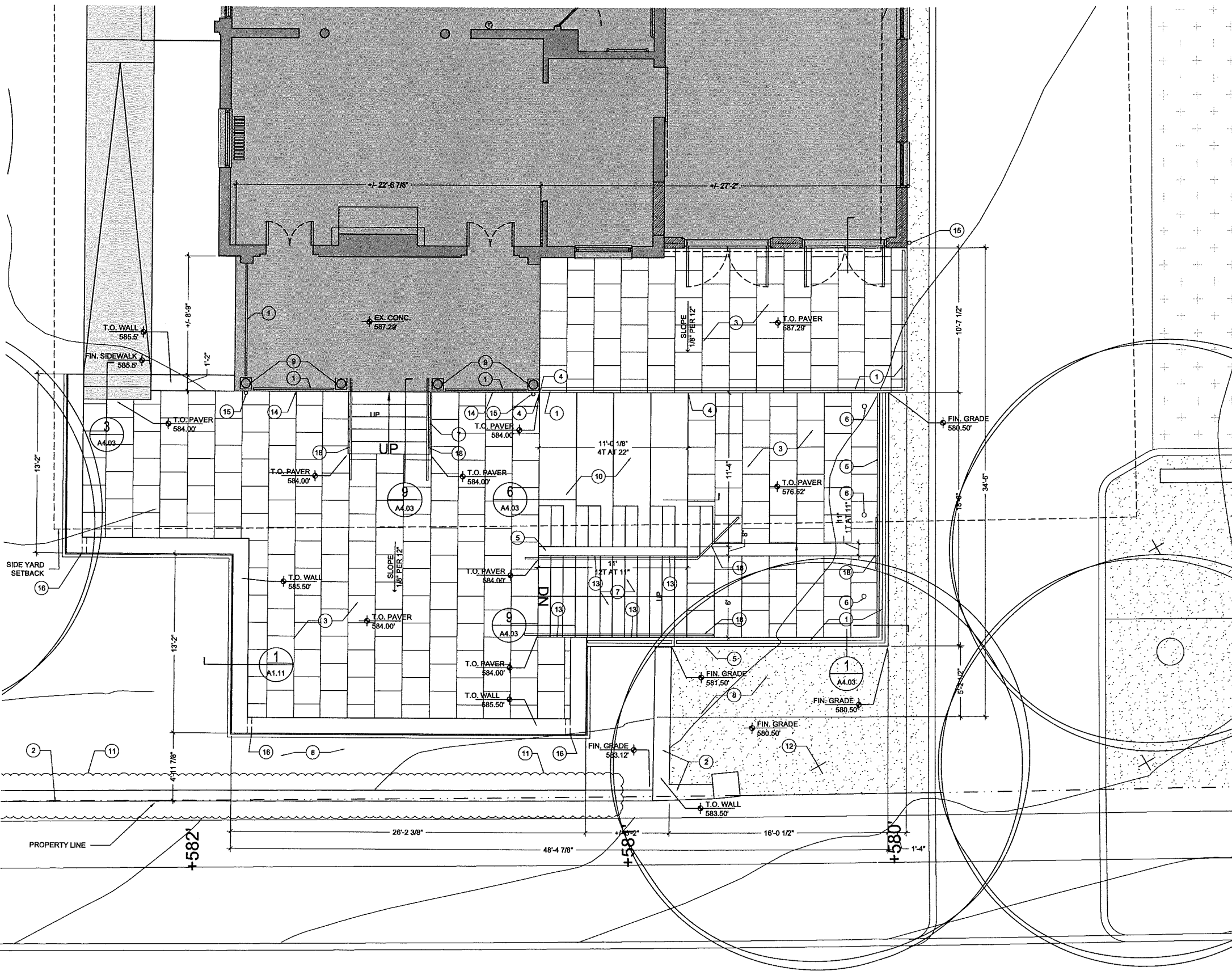

2
A1.05

KEYNOTES

- | | |
|---|---------------------------------------|
| 1 NEW METAL GUARDRAIL RE: SITE DETAILS | 10 NEW CAST IN PLACE CONCRETE BENCHES |
| 2 EXISTING RETAINING WALL | 11 EX. PRIVACY HEDGE |
| 3 NEW PRECAST PAVERS (24"x24") 910 SF | 12 NEW TREE RE: LANDSCAPE DWGS. |
| 4 PAVER START POINT | 13 STEP LIGHT (FIXTURE B) |
| 5 POURED IN PLACE CONCRETE RETAINING WALL | 14 FLOOD LIGHT ABOVE RE: ELEVATIONS |
| 6 AREA DRAIN RE: CIVIL DRAWINGS | 15 DOWNSPOUT |
| 7 NEW CONCRETE STAIR WITH PRECAST TREADS | 16 OVERFLOW RE: SITE DRAWINGS |
| 8 NEW PLANTING BED RE: LANDSCAPE DWGS. | 17 OVERFLOW RE: EXTERIOR DETAILS |
| 9 EX. WOOD COLUMN | 18 HANDRAIL RE: 11/A1.11 |

KEY NOTES

5
A1.05

SHEET NOTES:

- REFER TO ARCHITECTURAL SITE PLAN FOR ITEMS AND DIMENSIONS NOT NOTED.

SHEET NOTES / LEGEND

1
A1.05

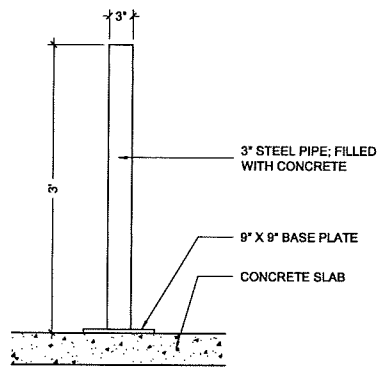

BOLLARD DETAIL
1" = 1'-0"

12
A1.11

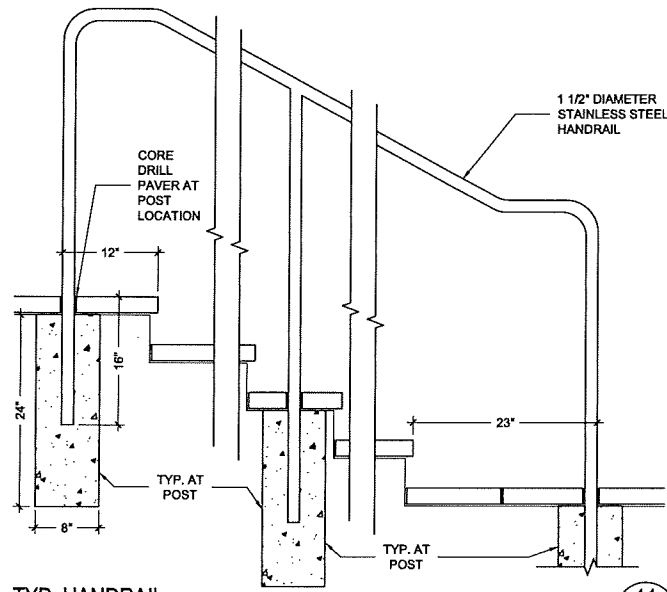

TYP. HANDRAIL
1" = 1'-0"

11
A1.11

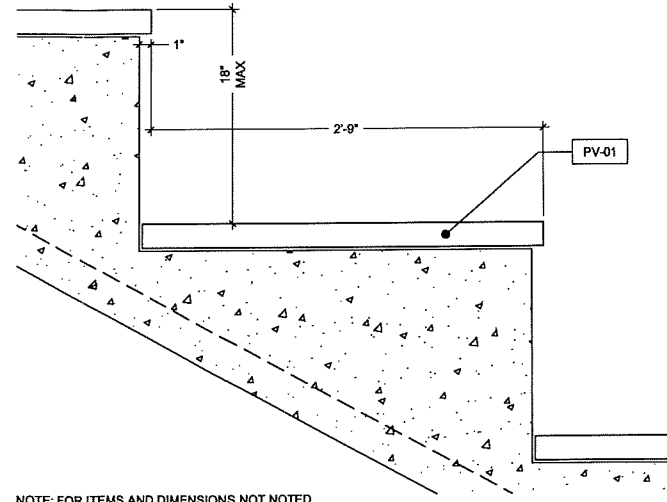

NOTE: FOR ITEMS AND DIMENSIONS NOT NOTED REFER TO 1/A1.11

TYP. SEATING STEP
1 1/2" = 1'-0"

10
A1.11

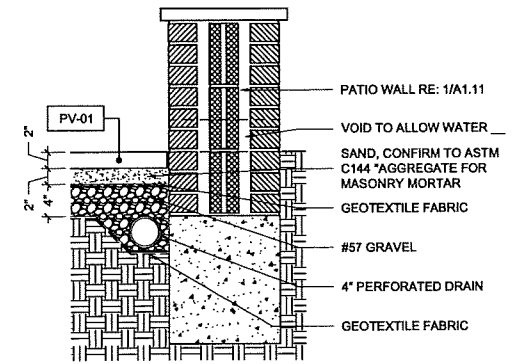

NOTE: FOR ITEMS AND DIMENSIONS NOT NOTED REFER TO 1/A1.11

PATIO WALL DETAIL AT OVERFLOW
1" = 1'-0"

9
A1.11

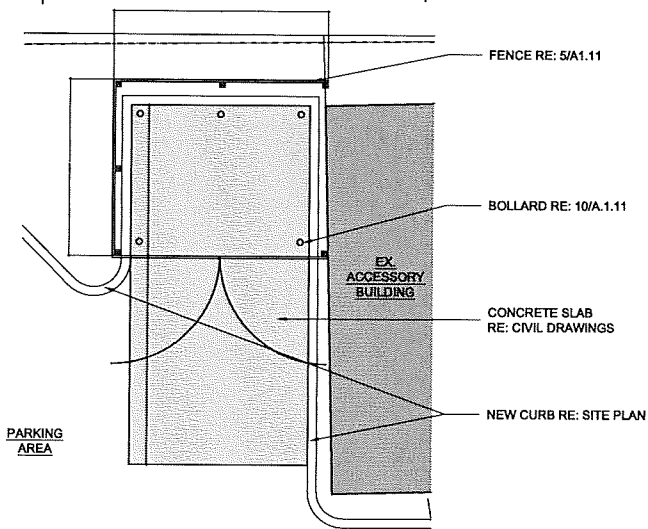

TRASH ENCLOSURE - PARTIAL PLAN
3/16" = 1'-0"

8
A1.11

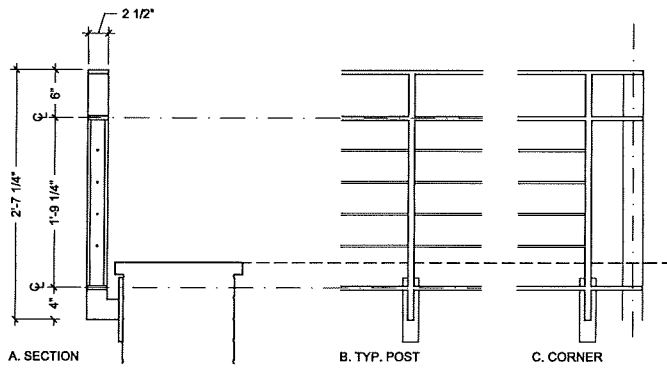

TYP. GUARDRAIL AT WALL
1" = 1'-0"

7
A1.11

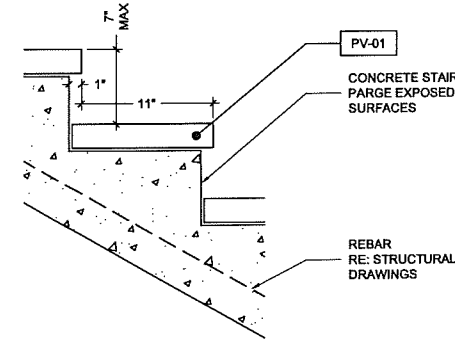

TYP. EXTERIOR TREAD
1 1/2" = 1'-0"

6
A1.11

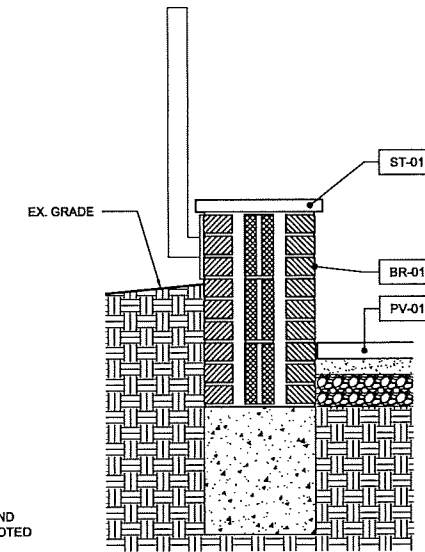

NOTE: FOR ITEMS AND DIMENSIONS NOT NOTED REFER TO 1/A1.11

PATIO / RETAINING WALL
1" = 1'-0"

5
A1.11

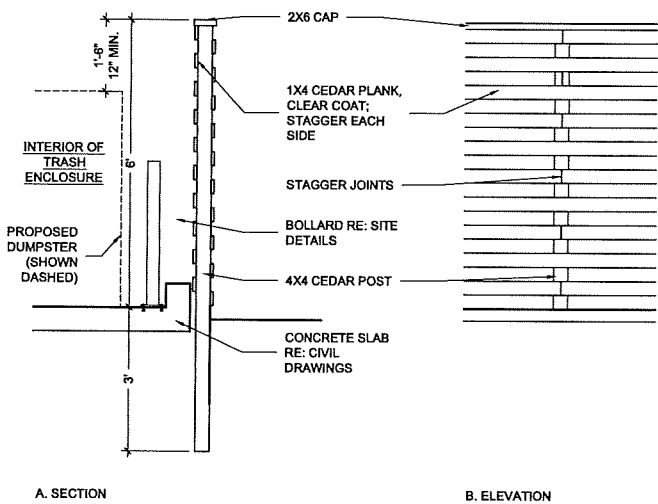

TRASH ENCLOSURE - DETAILS
1/2" = 1'-0"

4
A1.11

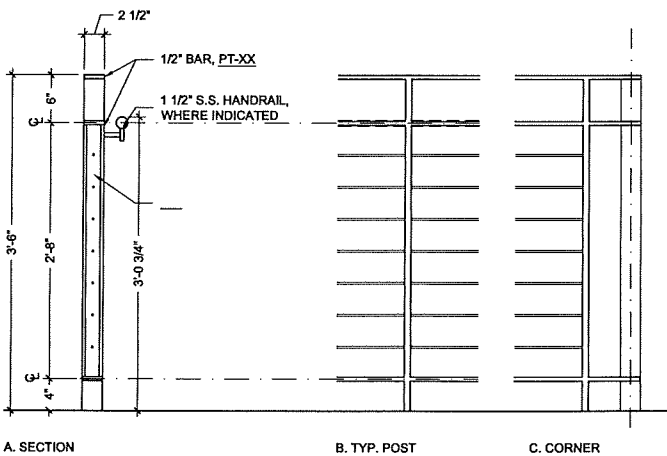

TYP. GUARDRAIL
1" = 1'-0"

3
A1.11

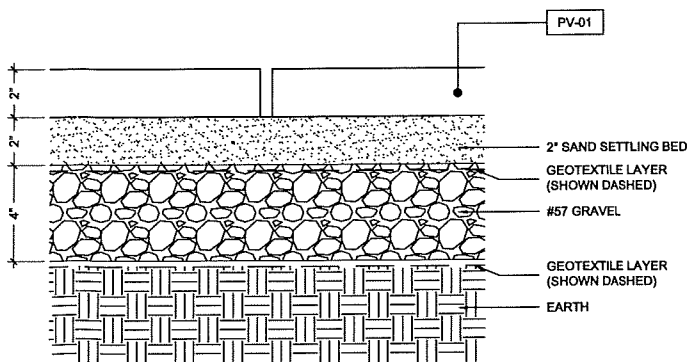

TYP. PATIO SECTION
3" = 1'-0"

2
A1.11

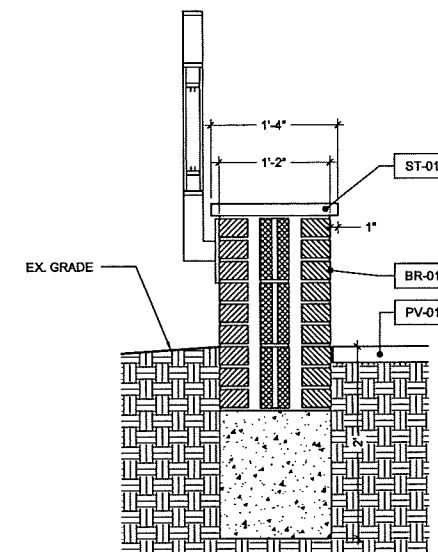

PATIO WALL
1" = 1'-0"

1
A1.11

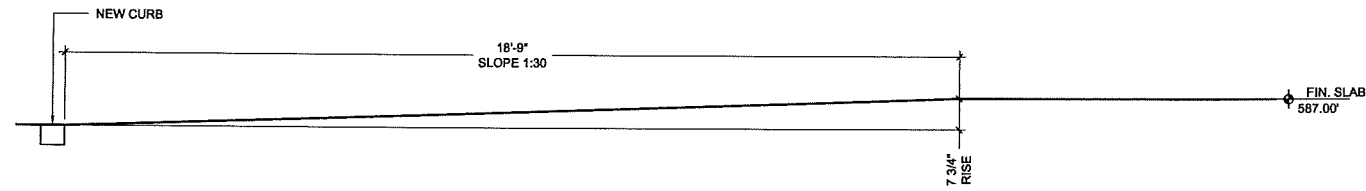

RAMP - NORTH
1/2" = 1'-0" 7
A1.12

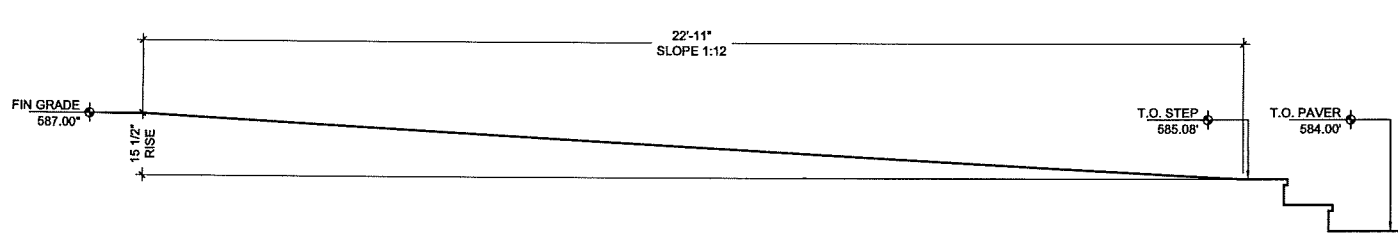

RAMP - SOUTH
1/2" = 1'-0" 3
A1.12

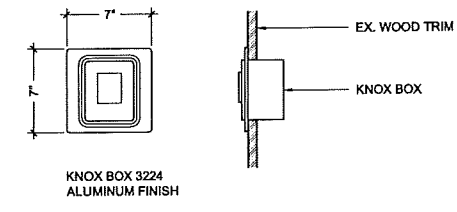

FIRE DEPARTMENT KNOX BOX
1 1/2" = 1'-0" 6
A1.12

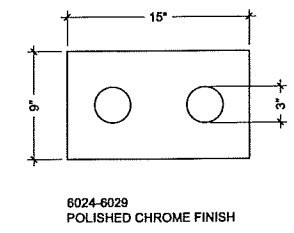

FIRE DEPARTMENT CONNECTION
1 1/2" = 1'-0" 2
A1.12

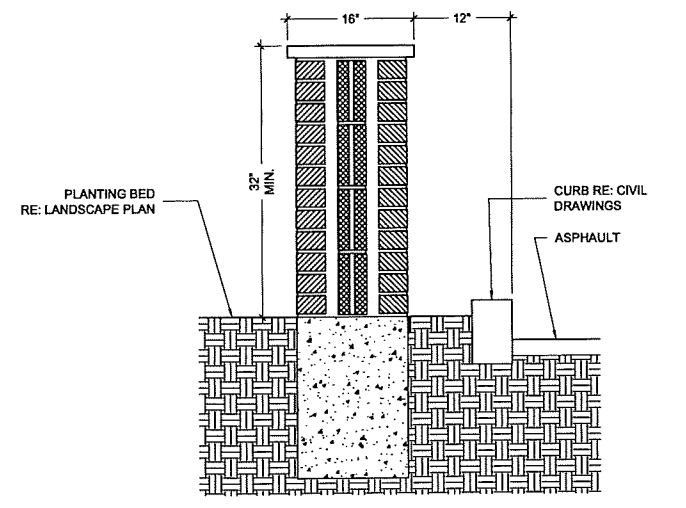

PARKING SCREEN WALL
1" = 1'-0" 9
A1.12

SIGNS
1" = 1'-0" 5
A1.12

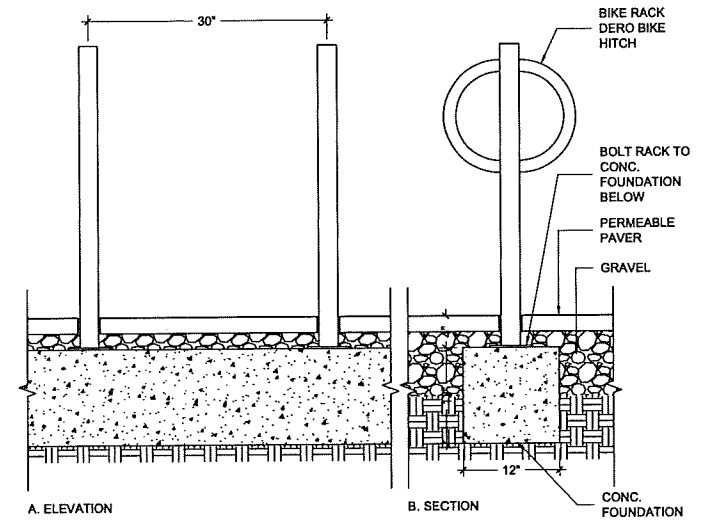

BIKE RACK
1" = 1'-0" 1
A1.12

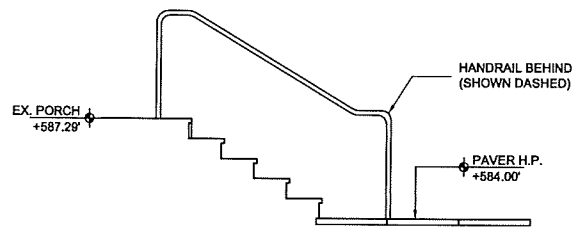

PARTIAL SECTION AT PATIO STAIR
3/8" = 1'-0"

9
A4.03

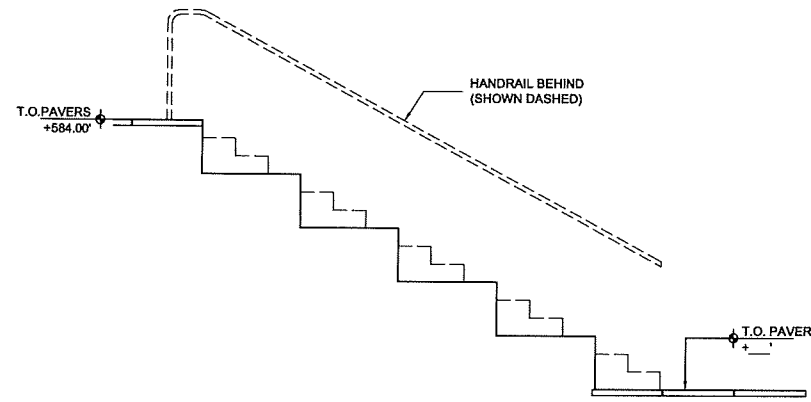

PARTIAL SECTION AT SUNKEN COURTYARD SEATING
3/8" = 1'-0"

6
A4.03

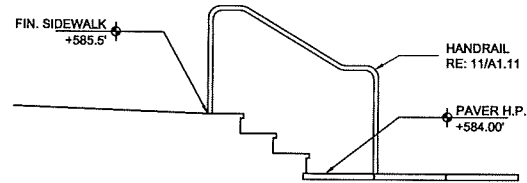

PARTIAL SECTION AT SITE STAIR
3/8" = 1'-0"

3
A4.03

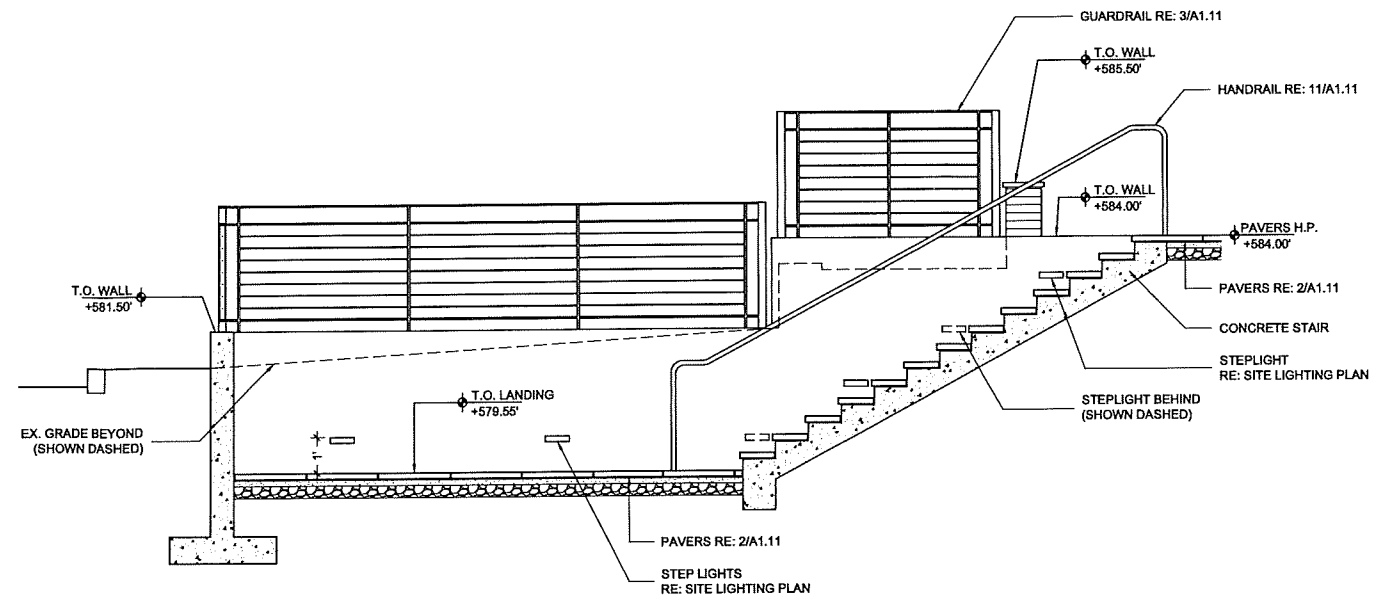

PARTIAL SECTION AT SUNKEN COURTYARD STAIR
3/8" = 1'-0"

9
A4.03

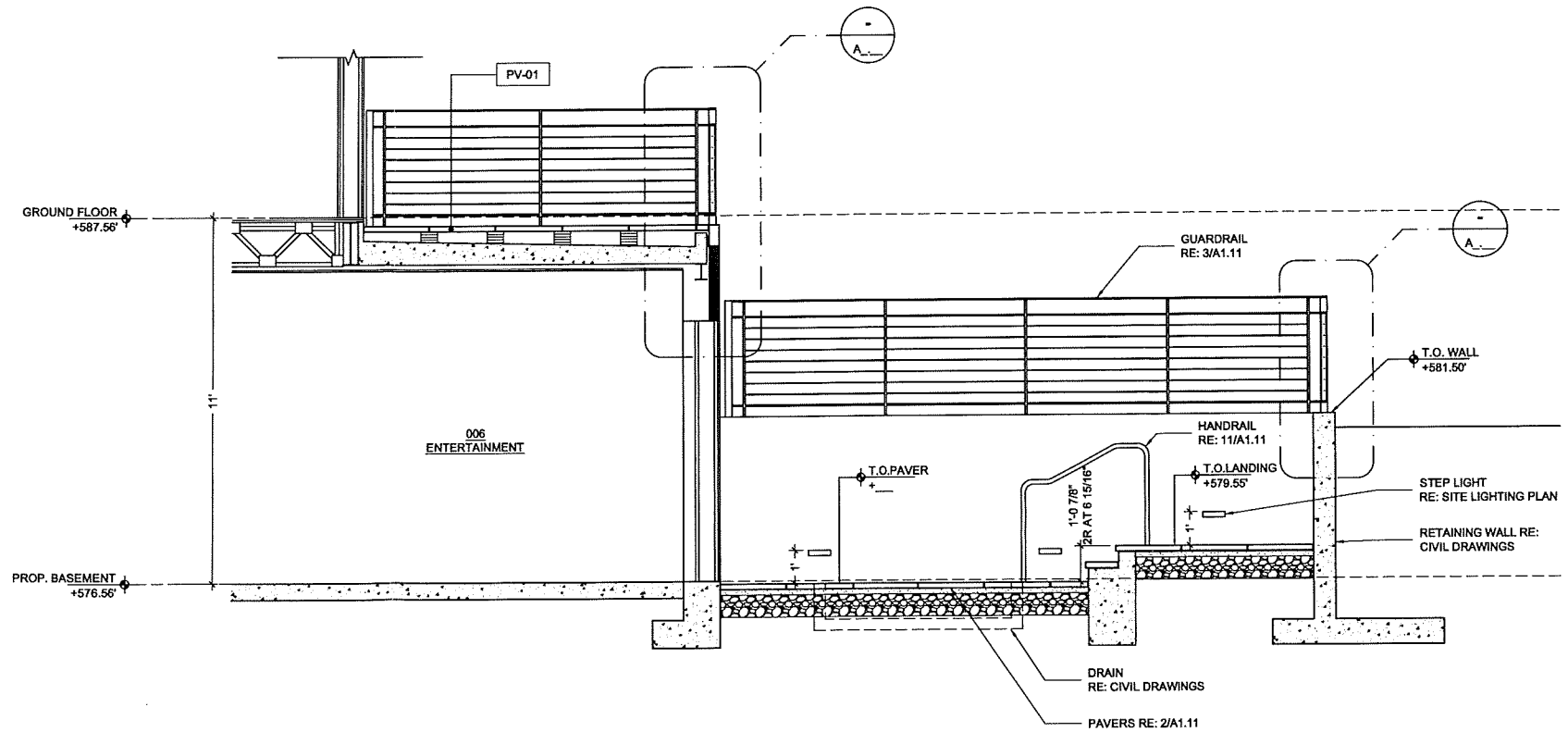

PARTIAL SECTION AT ENTERTAINMENT / SUNKEN COURTYARD
3/8" = 1'-0"

1
A4.03