

# Architectural And Historic Survey



## Identification

STREET ADDRESS: 110 Fourth Street N. E.

MAP & PARCEL: 53-57

CENSUS TRACT AND BLOCK: 1-118

PRESENT ZONING: B-4

ORIGINAL OWNER: W. G. Gillespie

ORIGINAL USE: Tinner's Store?

PRESENT USE: Gift Shop

PRESENT OWNER: J. Dean Tilman, Jr., G. McNeir Tilman,

ADDRESS: & William T. Tilman

310 E. Main Street

Charlottesville, Virginia

HISTORIC NAME: Gillespie-Tilman Building

DATE / PERIOD: 1884

STYLE: Victorian

HEIGHT (to cornice) OR STORIES: 2 storeys

DIMENSIONS AND LAND AREA: 22.25' x 55.9' (1243.8 sq. ft.)

CONDITION: Good

SURVEYOR: Bibb

DATE OF SURVEY: Winter 1980

SOURCES: City/County Records

Sanborn Map Co. - 1886

Charlottesville City Directories

J. Dean Tilman, Jr.

## ARCHITECTURAL DESCRIPTION

This is one of a group of three nearly identical buildings, all two storeys tall. This center building is three bays wide and projects slightly beyond the other two. Construction is of brick laid in stretcher bond on the facade, with an occasional header-stretcher course. The facade of this building is painted gray-green. Each building has a recessed central entrance, a simple wooden storefront cornice, plain frieze, and canvas awning. Windows at the second level are circular-headed, double-sash, 2-over-2 light, with wooden sills. There are slight variations in window width and spacing among the three buildings. Those in this center building are somewhat wider and set closer together. The entire facade of this building is recessed slightly between plain brick corner piers, with the recession corbelled out above the second storey. Each facade is crowned by an elaborate three-part brick parapet entablature with cornice brackets and paneled frieze. Behind the parapet, a shed roof slopes to the rear.

## HISTORICAL DESCRIPTION

In 1879 J. N. Pearce and W. G. Gillespie purchased the building on Union Street in which they had been operating a "tinner's store" (ACDB 75-142). Gillespie bought out Pearce's share the next year (ACDB 77-197). Gillespie replaced the old building with the present one in 1884, and Mrs. Lawson Turner built a similar one on each side of it the same year. Gillespie apparently continued to operate his tinner's store there until the building was sold to F. M. McCue in 1900 (City DB 10-265). Mrs. Turner's daughter Nannie T. Tilman (Mrs. J. Dean Tilman, Sr.) bought this building in 1912 (DB 23-487). She had inherited the building to the north and later purchased the one to the south as well. All three buildings remain in the Tilman family. The store room has had a number of occupants in this century, the longest probably being Bruton's Barber Shop from the mid-1930's until the early 1960's. Additional References: ACDB 85-254; City DB 7-8, 375-149; City WB 7-52.



# VIRGINIA HISTORIC LANDMARKS COMMISSION

File no. 104-72B  
Negative no(s). 5073-14

## SURVEY FORM

Historic name	Common name <u>PERSIMMON CORNER</u>
County/Town/City <u>ALBEMARLE / CHARLOTTESVILLE</u>	
Street address or route number <u>106<sup>110</sup> N. FOURTH ST.</u>	
USGS Quad <u>CHARLOTTESVILLE EAST VA.</u>	Date or period
Original owner	Architect/builder/craftsmen
Original use	
Present owner	Source of name
Present owner address	Source of date
	Stories
Present use	Foundation and wall const'n
Acreage	Roof type

State condition of structure and environs GOOD

State potential threats to structure

Note any archaeological interest

Should be investigated for possible register potential?    yes \_\_\_ no \_\_\_

Architectural description (Note significant features of plan, structural system and interior and exterior decoration, taking care to point out aspects not visible or clear from photographs. Explain nature and period of all alterations and additions. List any outbuildings and their approximate ages, cemeteries, etc.)

BRICK (5 COURSE ~~AMERICAN BOND~~ <sup>STRETCHER BOND</sup>); 2 STORY; SHED ROOF; 3 BAY. COMMERCIAL VERNACULAR. LATE 19TH CENTURY. CENTRAL ENTRANCE RECESSED UNDER 2ND STORY. PLATE GLASS DISPLAY CASES ON 1ST FLOOR. 2/2 SASH WINDOWS ON 2ND STORY. CORBELED BRICK BRACKETS ~~AND~~ CORNICE LINE. BRICK CORNER PILASTERS.

AND

Interior inspected?

Historical significance (Chain of title; individuals, families, events, etc., associated with the property.)

SANBORN MAPS  
1886: VACANT  
1891: VACANT

110 4th St NE

(same as 53-54)

23-487

Mannie T. Tilman

concrete found, brick walls, built-up flat roof  
metal ceiling  
old, 1900

1969, 1972 - interior alterations

1879 Woods est → Pearce + Gillespie

1880 Pearce → Gillespie

1896 Gillespie → M<sup>c</sup>Cue, deed of trust

1900 M<sup>c</sup>Cue → M<sup>c</sup>Cue

1912 M<sup>c</sup>Cue → Tilman

110 4th St NE

City DB

23-487 H.W. Walsh, commr in chancery case Samuel O. McLucie vs

7/6/1912 J Wm McLucie et al → Fannie T. Tilman, at auction #1910

lot of imp'ts at 110 4th St NE

same as 10-265, 2/21/1900

10-265 J. Samuel McLucie, under 1876 deed of trust fr. WB & CA

2/21/1900 Gillespie (DB 7-8), → F M McLucie at auction #1910

lots  
2-story brick bldg at 110 4th NE, 32' x 56'

same as

7-8 deed of trust

1/25/1896 2-story brick house

ACDB 85-255 WE & Cordelia D Gillegie → Mrs MP Turner & infant Chas Lawson H,

7/25/1885

Ruth L, & Nannie

"<sup>strip</sup> strip of land ... 5' x 56' ... point on Union St distant 44' 4" fr south wall of Frigell Bldg, east 56' to Monticello House property (now owned by AD Payne), south 5' to a point 14 1/2' fr a 15' alley, west 56' to Union St." see J W Dolin plat

# 108  
&  
# 110

(Mrs Turner made exchange of land w/ Gillegie some time ago "in order that she might make more eligible a certain building lot." Court, in Chancery cause of Turner v Turner, now orders that this exchange be ratified & considered as if owned by L C Turner at time of his death.)

"Gillegie has built a brick store room on the lot owned by him, incl said strip ... which is between 2 lots owned by Mrs Turner & Chas, & Mrs Turner has built a brick store room on each of sd lots belonging to her & Chas using N & S ..."

5' strips swapped

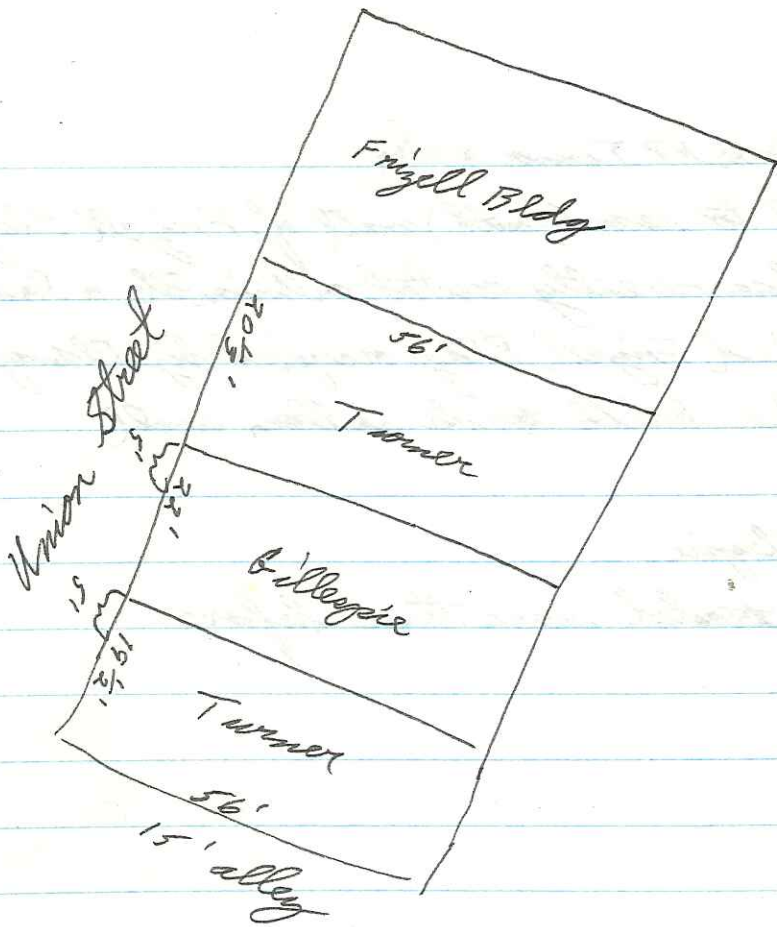

ACDB 75-142

Geo Perkins, spec commr in Chancery cause of Woods' wid vs Woods' heirs, → J N Pearce & W B Billegie

8/8/1879

#110

(Wm B Farish at one time purchased property, & sold to Pearce & Billegie) lot on Union St "upon which a bldg is located now used by sd Pearce & Billegie as a Turner's Store"

fr Turner's corner 16' fr house on this lot, & at south wall of ~~corner~~ 22'

Dr J C Long's brick bldg 22' south to lot bought by J C Turner, & 56' back

77-197

J N Pearce → W B Billegie

#400

9/30/1880

1/2 int in <sup>house</sup> lot on Park St now occupied by Billegie as a tea shop & bought fr Wm B Farish

#110

85-253 <sup>of Mary</sup> J. B. Frizell → Mrs M. P. Turner & chn #105  
7/25/1885 right to build to rear (south) wall of Frizell Bldg  
#114 "Mrs Turner has recently erected on Union St a brick store room  
inmed behind Frizell Bldg occupied by Flanagan, Peterson,  
& Frizell & has built to its southern wall

85-254 Turner → Gillespie  
• #110 5' x 56' steps graded some time before