

Architectural And Historic Survey



Identification

STREET ADDRESS: 102 East Main Street

MAP & PARCEL: 28-21

CENSUS TRACT AND BLOCK:

PRESENT ZONING: B-4

ORIGINAL OWNER: Hollis Rinehart

ORIGINAL USE:

PRESENT USE: Page W. Foster

PRESENT OWNER: 100 East Main Street

ADDRESS: Charlottesville, Virginia 22901

HISTORIC NAME: Rinehart-Levy Building

DATE / PERIOD: 1915, 1933, 1946, 1979

STYLE: No identifiable Style

HEIGHT (to cornice) OR STORIES: 1 storey

DIMENSIONS AND LAND AREA: 25.9' x 56.9' (2045 sq. ft.)

CONDITION: Good

SURVEYOR: Bibb

DATE OF SURVEY: Spring 1985

SOURCES: City Records The Daily Progress 5/2/1949
Alexander, Recollections of Early Ch'ville
Sanborn Map Co. - 1896, 1907, 1929-57, 1969

ARCHITECTURAL DESCRIPTION

In its present form, this building is one storey tall with a two-storey facade faced with pink marble. The storefront walls are faced with brick below multi-light display windows inside a shallow loggia. The entrance has been closed, and the only access now is through the adjacent store room at 100 East Main Street. Sweeping low over the storefront, an absolutely vertical wooden-shingled pent roof covers most of the marble facade and, more particularly, an elaborate second storey window arrangement dating from the early 1930's. Centered above the storefront is a large niche with a shaped display window set within it. On each side is a narrower window with a brightly colored peacock painted on a brick panel above it. The common stair that gave access to the second storeys of this building and the one at 106 East Main Street remains part of this building. The pent roof does not cover the marble facade in that area. There is a glass door with a transom at the first level. Above it is a small louvered second storey window. The plain parapet conceals a flat roof covered with tar and gravel.

HISTORICAL DESCRIPTION

In 1915 (City DB 27-181) Hollis Rinehart purchased a 2-storey duplex brick store building with living quarters above which had been built by John P. Halback between 1828 and 1842, and had been owned by the Carpenter family since 1883. Tax records indicate that Rinehart replaced it the same year with a 7-bay duplex store building, of which the eastern three bays remain at 106 East Main Street. The building was stuccoed and had a low tower in each end bay and a bellcast tiled roof over the center five bays. In 1924, Rinehart sold the western half of the building, 102 main Street to I. Daniel Levy (DB 46-457), whose family conducted a dress shop there for forty years. Levy completely rebuilt the facade c. 1932-33, and faced it with pink marble. The second storey and the rear of the building were destroyed by fire on April 30, 1949. The second storey was not rebuilt, but the 2-storey facade, which had survived the fire, was retained, and the second storey windows were covered with a large metal flounce. After Levy's moved to the Barracks Road Shopping Center in the early 1960's, a series of tenants occupied the store room before Page Foster purchased the building in 1979 (DB 399-529), connected the store room to the adjacent one at 100 East Main Street, and replaced the metal panel with a wooden shingled one.

Prog 5/2/49

Levy's fire - Sat night 4/30/49

102 E Main

worst fire in Ch'o since Valley View 2/(Sun)/46

Style Shoppe & O'Fallon Hawkins not burned,

beauty shop above 106 damaged some

Levy bldg was several feet higher than Hawkins

fire confined to back of bldg & 2nd storey

2-storey bldg w/ basement

picture shows ~~106~~ a peacock facade that's there now



1915

102-106 duplex built

1924

#102 sold to Levy

1949

#102 burned - pink marble facade, floor level \neq #106

100 E Main 102 E. Main (formerly 104)
 399-529 Page W. Foster 1979
 46-437 L. Daniel Levy 1924
 Hollis Rinehart

+ encl stairway to adjoining bldg
 1-5, $\frac{1}{2}$ base.

conc blk, brick walls, built-up flat roof

built 1950-51; 1932-1951

1979 - sprinkler; connect to adjacent bldg, remodeled

1975 - change storefront

1965 - " front & basement

Rinehart - Levy Bldg.

built 1915, 1933, , 1979

my notes, based on Sanborn, pictures, memory:

building 1915

facade c. 1924-1932 (covered since c. 1951)

fire 1949, 2nd storey removed

present

1 false front 1979

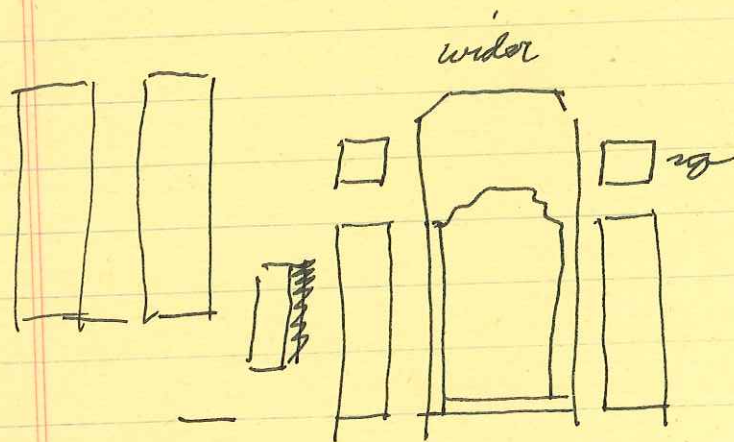

102 E Main

46-457 Hollie & Lena T. Rinehart → I. Daniel Levy \$29,000
3/1/1924 lot w/ bldgs on E side E Main adjacent to property sold
to W.O. Watson 1923
part of 27-181

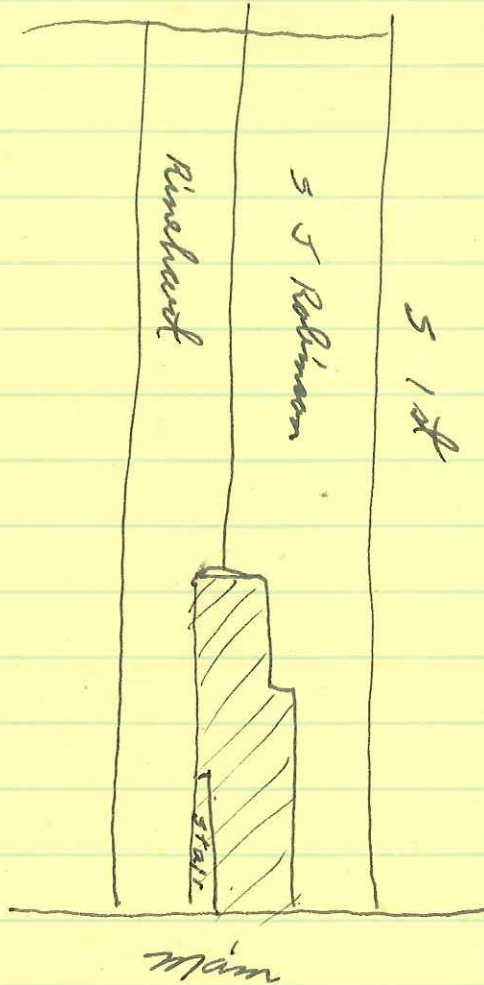

1931, ^{32, 33} 3rd	J D Levy	104 E Main	$12,800 + 9,000 = 21,800$
1930	"	"	$10,400 + 8,000 = 18,400$
1934	"	"	$12,800 + 13,000 = 25,800$ impts

description of what Page Foster covered
up c. 1980, after removing old Levy aluminum
false front.

Levy Bldg - 104 E. Main

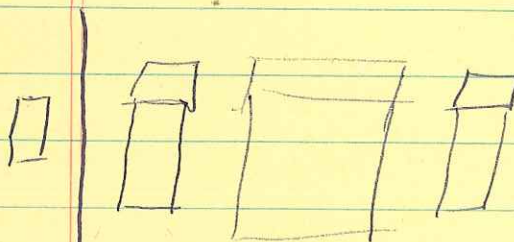

pink marble

large recessed center niche w/
shaped window

narrow window each side

bright-colored peacock painted
on brick above each side window

tops of windows even w/ tops of
100's windows - ~~and~~ ^{standing}

all this on a false front & later
hidden by metal flounce