



VIRGINIA
HISTORIC LANDMARKS COMMISSION
SURVEY FORM

File no. 104-72B
Negative no(s). 5073
5064-16

Historic name	HADEN BUILDING	Common name	WORRELL NEWSPAPERS INC.
County/Town/City	ALBEMARLE / CHARLOTTESVILLE		
Street address or route number	415 E. MARKET ST.		
USGS Quad	CHARLOTTESVILLE EAST VA	Date or period	
Original owner		Architect/builder/craftsmen	
Original use			
Present owner		Source of name	
Present owner address		Source of date	
		Stories	
Present use	COMMERCIAL	Foundation and wall const'n	
Acreage			
		Roof type	

State condition of structure and environs GOOD

State potential threats to structure
Note any archaeological interest

Should be investigated for possible register potential? yes ___ no ☒

Architectural description (Note significant features of plan, structural system and interior and exterior decoration, taking care to point out aspects not visible or clear from photographs. Explain nature and period of all alterations and additions. List any outbuildings and their approximate ages, cemeteries, etc.)

BRICK (7 COURSE AMERICAN BOND); 2 STORY; ^{hipped} GABLE ROOF;
2 BAY. VERNACULAR. 1910 (KEYSTONE). ARCHED ENTRANCE
WITH 8 PANEL DOOR AND 3 LIGHT TRANSOM IN 1ST WEST
BAY. ARCHED 9/9 SASH WINDOWS WITH BLINDS ON 1ST FLOOR.
PAIRED 9/9 SASH WINDOWS ON 2ND FLOOR. ORNATE TERRA
COTTA CORNICE. STRUCTURE ADJOINS DAILY PROGRESS
BUILDING (413 E. MARKET ST.)

Interior inspected?

Historical significance (Chain of title; individuals, families, events, etc., associated with the property.)

SANBORN MAPS:

1886 : HARNESS +
BARBER

1891 : HARNESS +
BOOTS + SHOES.

Published sources (Books, articles, etc., with bibliographic data.)

Names and addresses of persons interviewed

[illegible][illegible]

Name, address and title of recorder
KATE KLURANDA

LVA

Feb. 20

#604 27.85 X 50 (1493)
B-3

(formerly 201 5th NE)
415 E Market

Haden Bldg lot

21-235 225
Chas Alb Colman of Com 1981
339-283 T. Eugene Worrell, et al, 1972
332-302 Trustee for Worrell Newspapers Profit Sharing Inv Tr
Worrell Newspapers, Inc 1971
First Federal S & L Assoc 1966 merger
66-336 Va. State Bldg & Loan 1952 plat 216-443 (div)
Consolidated Realty Corp, 1938
93-454 Stuart Rothwell 1937

2-5, 347 1/2 Ave

brick found & walls, metal pipe roof
built 1911, good const

old Log Cabin Bar

1972 - remodeling, interior alterations

1966 - minor repairs

1954 - " , AC

1953 - basement floor & wall

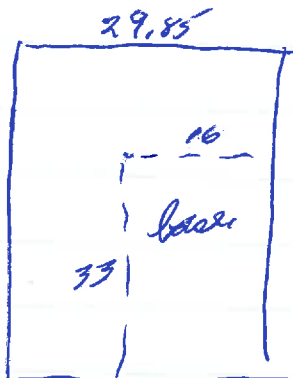

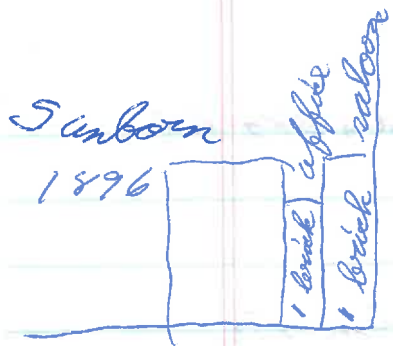

1920



City Dir

1953, ⁷³¹ 201-203 NE 5th - Va State Bldg & Loan Bldg

1927 Homer Kinney (lawyer) - 201

Haden Bldg - 203



5th & Market

43-454 owners of Va State Bldg & Loan Partnerships
8/2/1937 → Consolidated Realty Corp of Chi'o
the Haden Bldg, NW cor Mkt & 5th
same as ~~42-226~~ 58-321

58-321 John W & Mary L Fishburne, John S & Alice D White
10/1/1927 → E B Stevens, Tr for Va State Bldg & Loan \$17,000
Haden Bldg
same as 43-226

see

DB 22-63, 1910, G P Dixon → E B Haden
" 39-337, 1921, agreement of Lindsay

43-226 A L & Belle Belle Stevens → John W Fishburne &
1/28/1923 John S. White \$12,000
Haden Bldg, formerly Log Cabin Bar property
same as 42-285

42-285 W S & Cora L Hepler → A L Stevens \$14,000
2/14/1922 Haden Bldg
same as 42-54

42-54 R L Thomas (S) → W S Hepler
1/1/1922 same as 40-107, 3/1/22, for E. B. Haden

39-337 agreement bet E B Haden & J H Lindsay
1921 party wall agreement
Lindsay to build to northern wall of Haden Bldg

Tax

712,11 EB Haden mkt & 5th 800 + 1400 = 2500 ^{for Walker} ^{Bldg added}

2-42 Lillian B & Homer Richey → EB Haden
126/1910 'lot & bldg thereon known as the Log Cabin Box'
28' 1/4' on Market & 50' on 5th

2-63 close alley for mkt N →
2/21/1910

"Haden proposes to tear down old Log Cabin Box
bldg & erect new bldg"

~~building~~

5th + Market

2-5, sq, 2 bays ^{Market} ~~per side~~ 4 on 5th

6-c dm - but lots of differences - bad brick? openings altered several times?

low-pitched 55m hipped roof, Phila gutters, proj eaves, boxed cornice
der terra cotta frieze

rock-faced formed con ~~go~~ quoins ~~at~~ corner

wooden entab (?) = string course

windows = pr • 9/9, same ht, seg-^{arched} ~~headed~~ pr
at 1st level

W bay 1st level Market; single wind under W
one of pr above, + seg-^{8-paneled} ~~arched~~ ³⁻² door 9, transom
W of that

5 bay ^{1st} ~~Market~~ 5th; single wind under center of pr
3rd bay 5th - 12-2 doors/transom over ~~small~~
panels in place of sidelights

cent chim

~~corner~~ was open w/ ent on clipped corner,
windows to match added 1860's

corner stone (now painted white) at 5 end side wall
half way up: Haden Bldg / 1910

