



VIRGINIA HISTORIC LANDMARKS COMMISSION

File no. 104-70
Negative no(s). 5061(16)

SURVEY FORM

Historic name	Common name <u>Delta Upsilon House</u>
County/Town/City <u>Albemarle, Charlottesville</u>	
Street address or route number <u>180 Rugby Road</u>	
USGS Quad <u>Charlottesville west, Va.</u>	Date or period c. 1930 <u>c. 1927</u>
Original owner	Architect/builder/craftsmen
Original use	
Present owner <u>Delta Upsilon</u>	Source of name
Present owner address <u>180 Rugby Road</u>	Source of date
Present use <u>Fraternity</u>	Stories
Acreage	Foundation and wall const'n
	Roof type

State condition of structure and environs good

State potential threats to structure

Note any archaeological interest

Should be investigated for possible register potential? yes ___ no X

Architectural description (Note significant features of plan, structural system and interior and exterior decoration, taking care to point out aspects not visible or clear from photographs. Explain nature and period of all alterations and additions. List any outbuildings and their approximate ages, cemeteries, etc.)

180: brick (flemish bond); 2 1/2 stories, hip roof with 2 hip roof dormers; 5 bay; 5 bay brick terrace with iron railing. Georgian Revival. c. 1930. brick quoins, projecting center pavilion with pediment, entablature with soldier brick architrave, blank, dentilated frieze, modillion blocks. entrance in center bay has 4 Tuscan pilasters, full entablature with dentils and modillion blocks, frieze states "Delta Upsilon", five light transom. 8 over 8 light sash windows, 1st floor - jack arches, stone keys and sills. shutters. one interior chimney on north.

Interior inspected? no.

Historical significance (Chain of title; individuals, families, events, etc., associated with the property.)

/

/

formerly Beta Theta Pi House
not shown on 1907 or 1920 Sandborn maps.
Delta Upsilon bought in early 1970's.

Sources and bibliography
Published sources (Books, articles, etc., with bibliographic data.)

Primary sources (Manuscript documentary or graphic materials; give location.)

Names and addresses of persons interviewed

Plan (Indicate locations of rooms, doorways, windows, alterations, etc.)

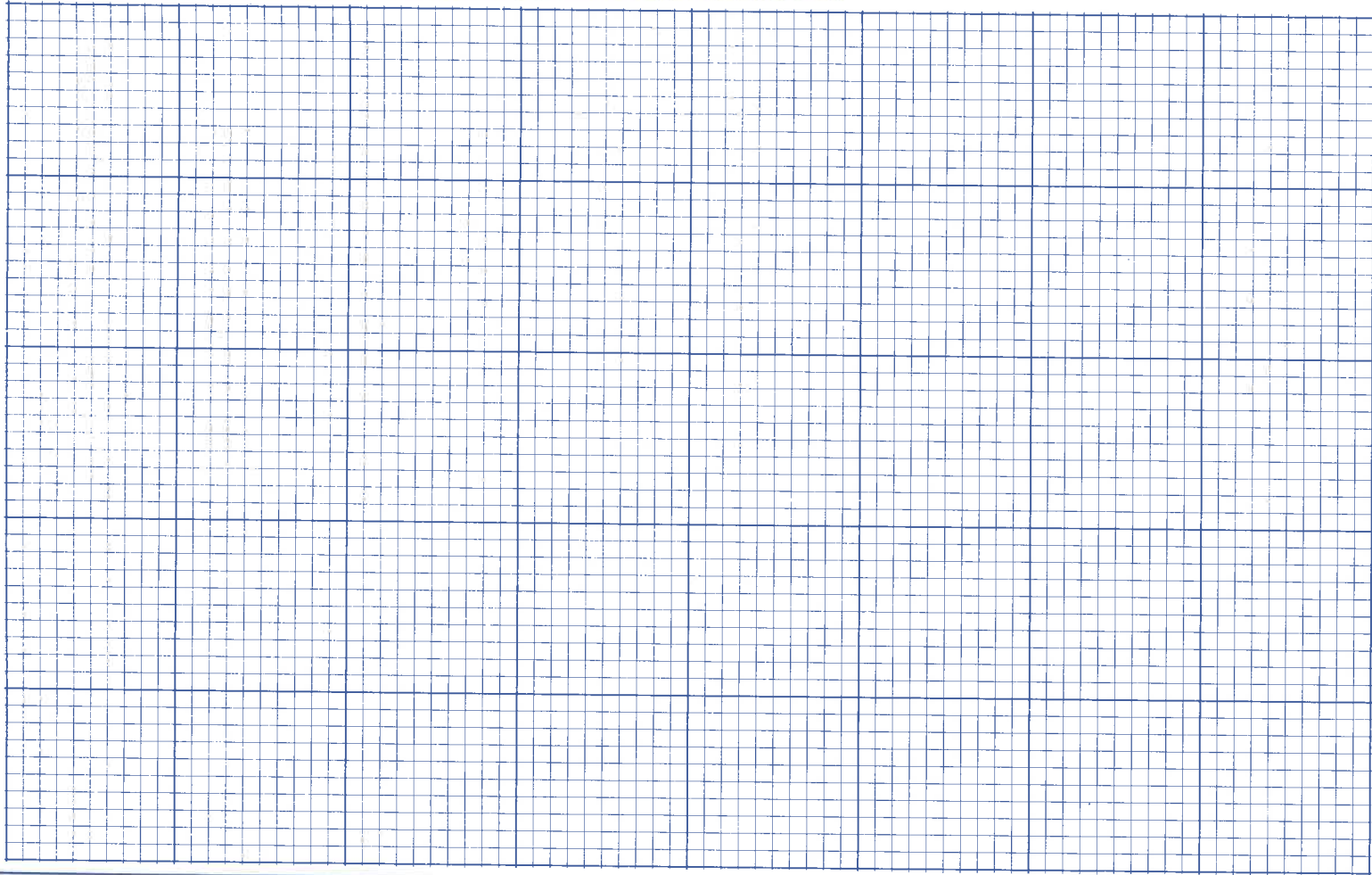

Site plan (Locate and identify outbuildings, dependencies and significant topographical features.)

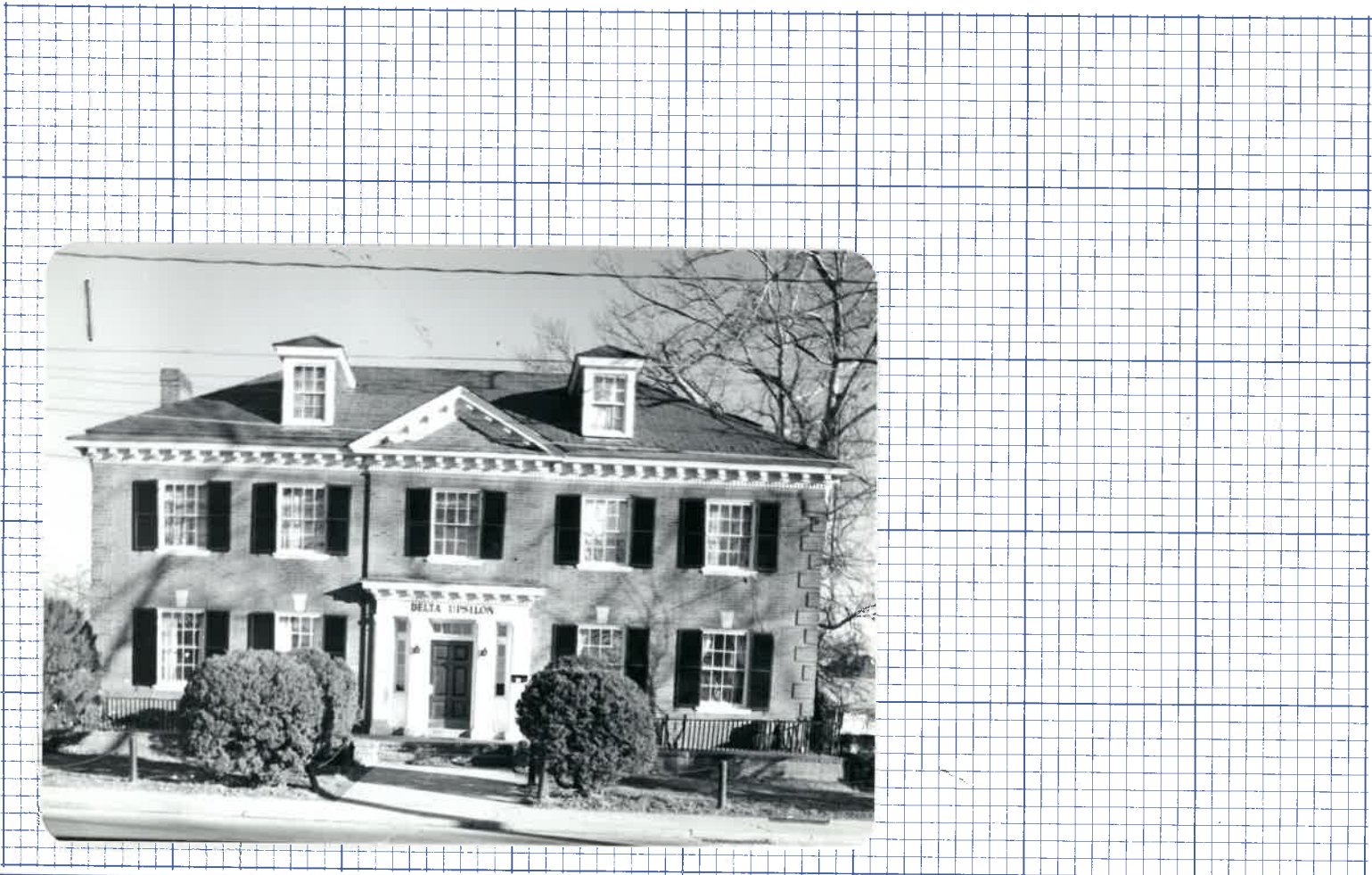

Name, address and title of recorder

Karen Kummer Univ. of Va. Arch. History Grad. Student

Date

March 1980

City of Charlottesville - Rugby Rd.-University Corner H.D.

DEPARTMENT OF HISTORIC RESOURCE
RECONNAISSANCE SURVEY FORM

DHR Identification Number: 104-0133-0002

Other DHR Number: 104-70

Property Date(s) 1929

PROPERTY NAMES

180 Rugby Road

EXPLANATION

Address-Current

Beta Theta Pi House

Historic

Delta Upsilon Fraternity House

Current

County/Independent City: Charlottesville

State: Virginia

Magisterial District:

Tax Parcel: 9-152-1-2

USGS Quad Map Name: CHARLOTTESVILLE WEST

UTMs of Boundary:

Center UTM:

Restrict location and UTM data? N

ADDRESSES

Number	Thoroughfare Name	Explanation
180 -	Rugby Road	Current

Vicinity: Town/Village/Hamlet: Charlottesville

Name of National Register Historic District:

Rugby Road-University Corner Historic District

Name of DHR Eligible Historic District:

Name of Local Historic District:

Physical Character of General Surroundings: City

Site Description/Notable Landscape Features:

On corner lot, sloping downward to rear; yard planted with evergreen shrubs, and front yard edged with rail fence; driveway behind building leads to parking adjoining building on south/southwest side.

Ownership: Private

NR Resource Type: Building

WUZITS

Seq. #	# of	Wuzit Types	Historic?
1.0	1	Single Dwelling	Historic

TOTAL: 1
Historic: 1
Non-Historic: 0

PRIMARY RESOURCE EXTERIOR COMPONENT DESCRIPTION

Component	#	Comp Type/Form	Material	Material Treatment
Cornice	0	Boxed	Wood	W/ Modillions
Dormer	4	Hip-roofed	Wood	
Foundation	0	Continuous	Brick	
Roof	0	Gable	Asphalt	Shingle
Walls	0	Masonry	Brick	6-course Amer.Bond
Window(s)	0	Sash, double-hung	Wood	1/1
Chimney	1	Interior	Brick	
Dormer	1	Gable-roofed	Wood	
Chimney	3	Semi-exterior	Brick	

INDIVIDUAL RESOURCE INFORMATION

SEQUENCE NUMBER: 1.0 WUZIT: Single Dwelling
Primary Resource? Yes
Estimated Date of Construction: 1929
Source of Date: Site Visit/Written
Architectural Style: Colonial Revival

Description:

Large rectangular block with two-and-one-half-story rear section on foundation with raised rear; both sections have hipped roofs, edged with ornate cornices which include modillion blocks on the front facade, and dentils on the other walls. Four hip-roofed dormers in main block, each with one-over-one double-hung sash window. Five-bay front facade has central entrance in Classical frontispiece with four three-quarter Doric columns supporting an entablature; a gabled dormer emphasizes the center bay. A semi-exterior chimney rises on the northeast side of the main block, with a one-over-one window breaking through on the second floor in the manner of Lutyens. The front facade's first-floor windows have jack arches and keystones; all windows on the front have window blinds.

Condition: Excellent

Threats to Resource: None Known

Additions/Alterations Description:

None.

Number of Stories: 2.5

Interior Plan Type:

Accessed? No

Interior Description:

Relationship of Secondary Resources to Property:

None.

DHR Historic Context: Domestic

Significance Statement:

This building was constructed in 1929, to designs by the Charlottesville

architect Stanislaw Makielski, for the Beta Theta Pi Fraternity. "Since 1916 Beta Theta Pi had tried to build a house on University land, but in 1929 it chose instead to be on Rugby Road, across from Zeta Psi and near to the newly completed Phi Kappa Psi". Makielski envisioned another quadrangle formed by fraternity houses, similar to the arrangement on the northwest side of Rugby Road, for the site occupied by this house and adjoining land contained in the area between Chancellor Street, Rugby Road, and Madison Bowl; this plan was dropped when Phi Kappa Psi decided to build a house overlooking Madison Bowl (VDHR resource nos. 104-133-10, 104-67) (Bishop 1981: 17, 16). The Beta House was the last University of Virginia fraternity house to be built south of the railroad tracks, and it gave its name to Beta Bridge, located immediately to the north (VDHR resource no. 104-133-1) (Sanborn 1907, 1913, 1920, 1929, 1941, 1969; O'Dell 1983).

GRAPHIC DOCUMENTATION

Medium	Medium ID #	Frames	Date
B&W 35mm Photos	14646	3 - 5	3/ 9/1996
B&W 35mm Photos	14645	36 -	3/ 9/1996

BIBLIOGRAPHIC DATA

Sequence #: 1.1 Bibliographic Record Type: Survey, Other
 Author: O'Dell, Jeffrey M.
 Citation Abbreviation:
 Virginia Historic Landmarks Commission (VHLC) Survey
 Notes:
 Sept. 1983. VDHR Archives.

Sequence #: 1.2 Bibliographic Record Type: Map
 Author: Sanborn Map Company
 Citation Abbreviation:
 Sanborn Fire Insurance Maps, Charlottesville, VA
 Notes:
 Published by Sanborn Map Company, 1907, 1913, 1920, 1929, 1941, 1969.
 University of Virginia Library Government Documents.

Sequence #: 1.2 Bibliographic Record Type: Book
 Author: Bishop, Timothy L.
 Citation Abbreviation:
 Fraternity Houses at the University of Virginia
 Notes:
 Undergraduate Architectural History Independent Study, University of Virginia, 1981. University of Virginia Fiske Kimball Library.

CULTURAL RESOURCE MANAGEMENT EVENTS

Date: 3/ 2/1996
 Cultural Resource Management Event: Reconnaissance Survey
 Organization or Person: Smead, Susan E.
 ID # Associated with Event:
 CRM Event Notes or Comments:

MAILING ADDRESS

Honorif:
 First :
 Last :
 Suffix :

Title :

Company: VA Delta Upsilon Alumni Assoc., Inc.

Address: Mincer - 1527 University Avenue

City : Charlottesville

State: VA

Zip : 22903- Country: USA

Phone/extension:

Individual Category Codes:

Mailing Address Notes:

Surveyor's Notes:

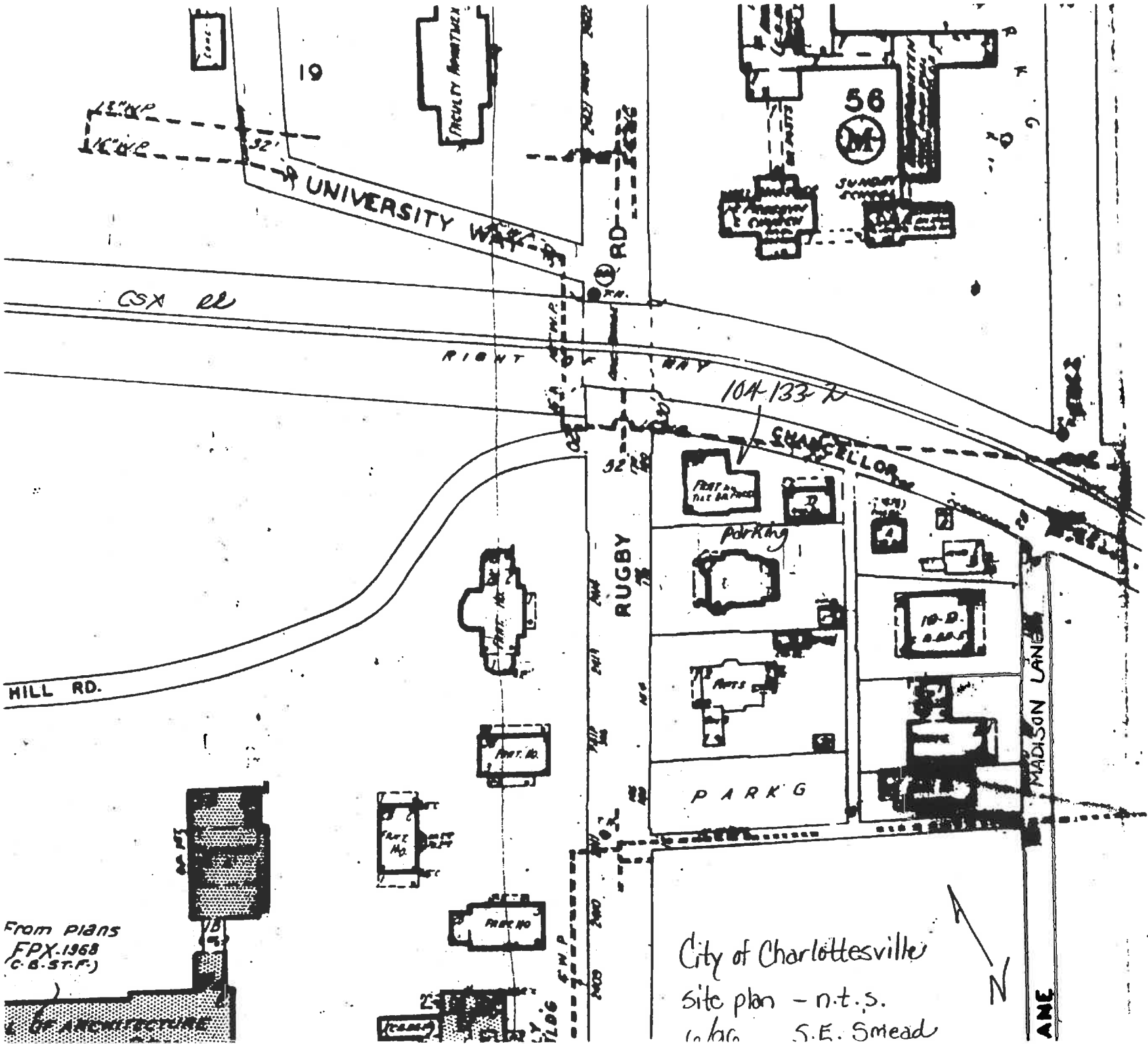

From plans
 FPX-1968
 (C.B. ST.F.)

OF ARCHITECTURE

City of Charlottesville
 site plan - n.t.s.
 in lga S.E. Smead

ANE

CITY OF CHARLOTTESVILLE

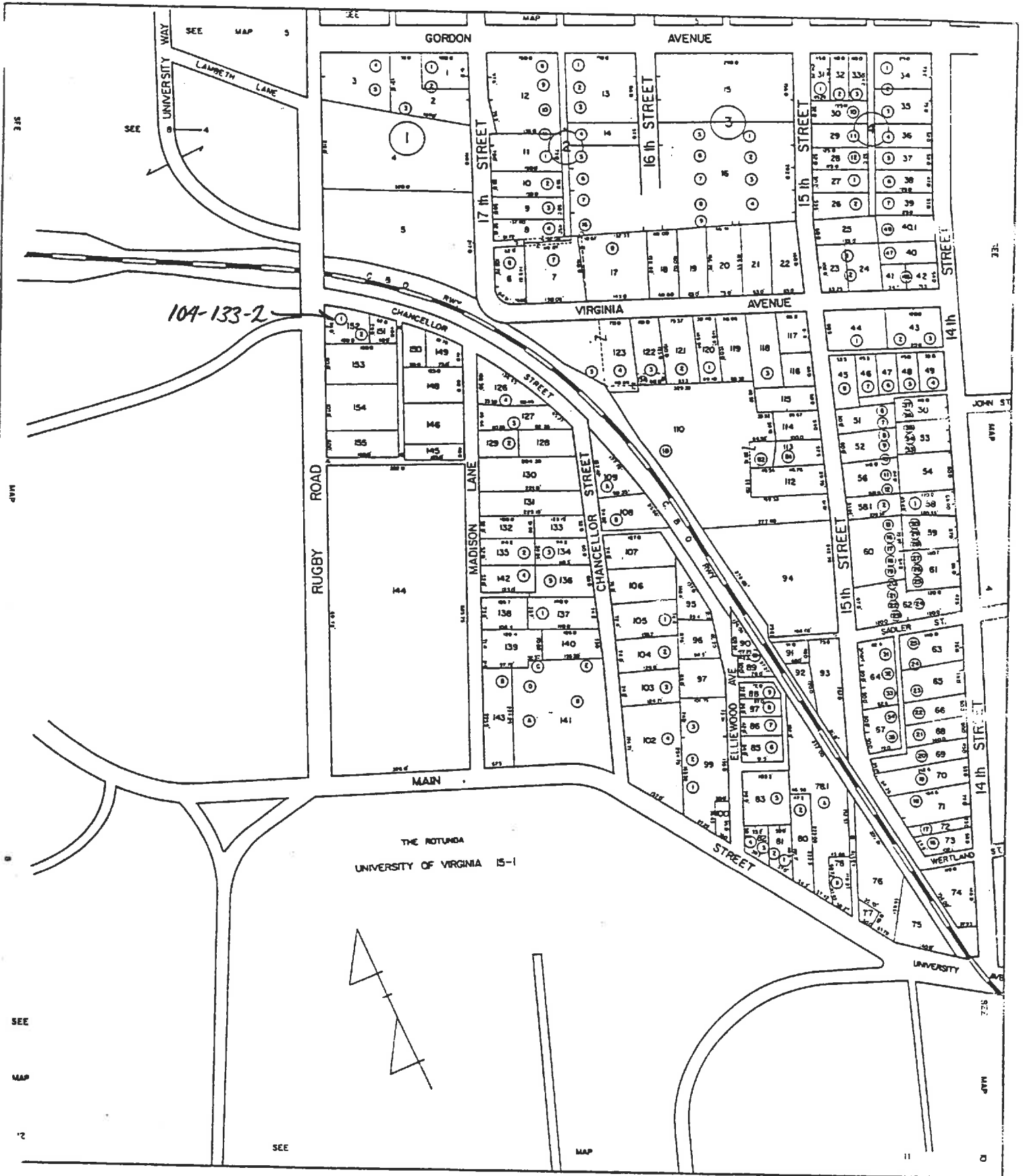

SCALE 1" = 100'

SECTION: 9



VIRGINIA HISTORIC LANDMARKS COMMISSION

HISTORIC DISTRICT SURVEY FORM

File No. 104-130-2
Negative no(s). 7297

Page 1 of 2

Street address 180 Rugby Road
Town/City Charlottesville

Present name: Delta Upsilon House
Common name

Historic name Beta Theta Pi House

- Material**
- wood frame (siding: weatherboard, shingle, aluminum, bricktex, _____)
 - brick (bond: Flemish, stretcher, _____-course American, _____)
 - stone (random rubble, random ashlar, coursed ashlar, _____)
 - log (siding: weatherboard, shingle, aluminum, bricktex, _____)
 - stucco cast iron
 - concrete block terra cotta
 - enameled steel glass and metal
 - other: _____

Number of Stories	Roof Type	Roof Material
<input type="checkbox"/> 1 <input checked="" type="checkbox"/> 2½ <input type="checkbox"/> 1½ <input type="checkbox"/> 3 <input type="checkbox"/> 2 <input type="checkbox"/> _____	<input type="checkbox"/> shed <input type="checkbox"/> mansard <input checked="" type="checkbox"/> gable <input type="checkbox"/> gambrel <input type="checkbox"/> pediment <input type="checkbox"/> parapet <input type="checkbox"/> hipped <input type="checkbox"/> flat <input type="checkbox"/> other: _____	<input checked="" type="checkbox"/> slate <input type="checkbox"/> tile <input type="checkbox"/> wood shingle <input type="checkbox"/> pressed tin <input type="checkbox"/> composition <input type="checkbox"/> not visible <input type="checkbox"/> standing seam metal <input type="checkbox"/> other: _____

Dormers	Number of bays — Main facade
<input type="checkbox"/> 0 <input type="checkbox"/> 3 <input type="checkbox"/> shed <input checked="" type="checkbox"/> hipped <input type="checkbox"/> 1 <input type="checkbox"/> 4 <input type="checkbox"/> gable <input type="checkbox"/> _____ <input checked="" type="checkbox"/> 2 <input type="checkbox"/> _____ <input type="checkbox"/> pedimented	<input type="checkbox"/> 1 <input type="checkbox"/> 4 <input type="checkbox"/> 7 <input type="checkbox"/> 2 <input checked="" type="checkbox"/> 5 <input type="checkbox"/> 8 <input type="checkbox"/> 3 <input type="checkbox"/> 6 <input type="checkbox"/> _____

Porch	Stories	Bays	General description
<input type="checkbox"/> yes <input checked="" type="checkbox"/> no	<input type="checkbox"/> 1 <input type="checkbox"/> 3 <input type="checkbox"/> 2 <input type="checkbox"/> _____	<input type="checkbox"/> 1 (center) <input type="checkbox"/> 2 <input type="checkbox"/> 4 <input type="checkbox"/> 1 (side) <input type="checkbox"/> 3 <input type="checkbox"/> _____	no porch

Building type

<input type="checkbox"/> detached house	<input type="checkbox"/> garage	<input type="checkbox"/> government	<input type="checkbox"/> industrial
<input type="checkbox"/> detached town house	<input type="checkbox"/> farmhouse	<input type="checkbox"/> commercial (office)	<input type="checkbox"/> school
<input type="checkbox"/> row house	<input type="checkbox"/> apartment building	<input type="checkbox"/> commercial (store)	<input type="checkbox"/> church
<input type="checkbox"/> double house	<input type="checkbox"/> gas station	<input type="checkbox"/> railroad	<input checked="" type="checkbox"/> <u>fraternity</u>

Style/period Georgian Revival Date 1929 Architect/builder Stanislaw Makielski

Location and description of entrance Central entry with elaborate Classical frontispiece featuring four pilasters, sidelights and toplight.



Miscellaneous descriptive information (plan, exterior and interior decoration, cornice/eave type, window type and trim, chimneys, additions, alterations)

This is one of the few fraternity houses of its period in Charlottesville without a porch or portico. Following traditional Virginia Georgian forms, it has a prominent modillion wood cornice, a Classical door frame, and good-quality brickwork in Flemish bond with jack arches at the windows. The small decorative front pediment enlivens the facade.

Historical information

The last UVa fraternity house to be erected south of the railroad tracks, the Beta house was built for the Beta Theta Pi fraternity house, which occupied it until the local chapter became inactive in 1972. The local chapter of Delta Upsilon has occupied it since 1973.

The Beta house gave its name to nearby "Beta Bridge" just northwest.

Source City directories; Eugenia Bibb; T. Bishop, "Fraternities at UVa"

Surveyed by Jeff O'Dell, VHLC Date 9-83



VIRGINIA HISTORIC LANDMARKS COMMISSION

HISTORIC DISTRICT SURVEY FORM

File No. 104-130
Negative no(s) 7297

Page 1 of 2

Street address 180 Rugby Road
Town/City Charlottesville
Historic name Beta Theta Pi House Present name: Delta Upsilon House
Common name

Material wood frame (siding: weatherboard, shingle, aluminum, bricktex, _____)
 brick (bond: Flemish, stretcher, _____-course American, _____)
 stone (random rubble, random ashlar, coursed ashlar, _____)
 log (siding: weatherboard, shingle, aluminum, bricktex, _____)
 stucco cast iron
 concrete block terra cotta
 enameled steel glass and metal
 other: _____

Number of Stories	Roof Type	Roof Material
<input type="checkbox"/> 1 <input checked="" type="checkbox"/> 2 1/2 <input type="checkbox"/> 1 1/2 <input type="checkbox"/> 3 <input type="checkbox"/> 2 <input type="checkbox"/> _____	<input type="checkbox"/> shed <input type="checkbox"/> mansard <input checked="" type="checkbox"/> gable <input type="checkbox"/> gambrel <input type="checkbox"/> pediment <input type="checkbox"/> parapet <input type="checkbox"/> hipped <input type="checkbox"/> flat <input type="checkbox"/> other: _____	<input checked="" type="checkbox"/> slate <input type="checkbox"/> tile <input type="checkbox"/> wood shingle <input type="checkbox"/> pressed tin <input type="checkbox"/> composition <input type="checkbox"/> not visible <input type="checkbox"/> standing seam metal <input type="checkbox"/> other: _____

Dormers	Number of bays — Main facade
<input type="checkbox"/> 0 <input type="checkbox"/> 3 <input type="checkbox"/> shed <input checked="" type="checkbox"/> hipped <input type="checkbox"/> 1 <input type="checkbox"/> 4 <input type="checkbox"/> gable <input type="checkbox"/> _____ <input checked="" type="checkbox"/> 2 <input type="checkbox"/> _____ <input type="checkbox"/> pedimented	<input type="checkbox"/> 1 <input type="checkbox"/> 4 <input type="checkbox"/> 7 <input type="checkbox"/> 2 <input checked="" type="checkbox"/> 5 <input type="checkbox"/> 8 <input type="checkbox"/> 3 <input type="checkbox"/> 6 <input type="checkbox"/> _____

Porch	Stories	Bays	General description
<input type="checkbox"/> yes <input checked="" type="checkbox"/> no	<input type="checkbox"/> 1 <input type="checkbox"/> 3 <input type="checkbox"/> 2 <input type="checkbox"/> _____	<input type="checkbox"/> 1 (center) <input type="checkbox"/> 2 <input type="checkbox"/> 4 <input type="checkbox"/> 1 (side) <input type="checkbox"/> 3 <input type="checkbox"/> _____	no porch

Building type

<input type="checkbox"/> detached house	<input type="checkbox"/> garage	<input type="checkbox"/> government	<input type="checkbox"/> industrial
<input type="checkbox"/> detached town house	<input type="checkbox"/> farmhouse	<input type="checkbox"/> commercial (office)	<input type="checkbox"/> school
<input type="checkbox"/> row house	<input type="checkbox"/> apartment building	<input type="checkbox"/> commercial (store)	<input type="checkbox"/> church
<input type="checkbox"/> double house	<input type="checkbox"/> gas station	<input type="checkbox"/> railroad	<input checked="" type="checkbox"/> fraternity

Style/period Georgian Revival Date 1929 Architect/builder ~~xxxx~~ Stanislaw Makielski

Location and description of entrance Central entry with elaborate Classical frontispiece featuring four pilasters, sidelights and toplight.

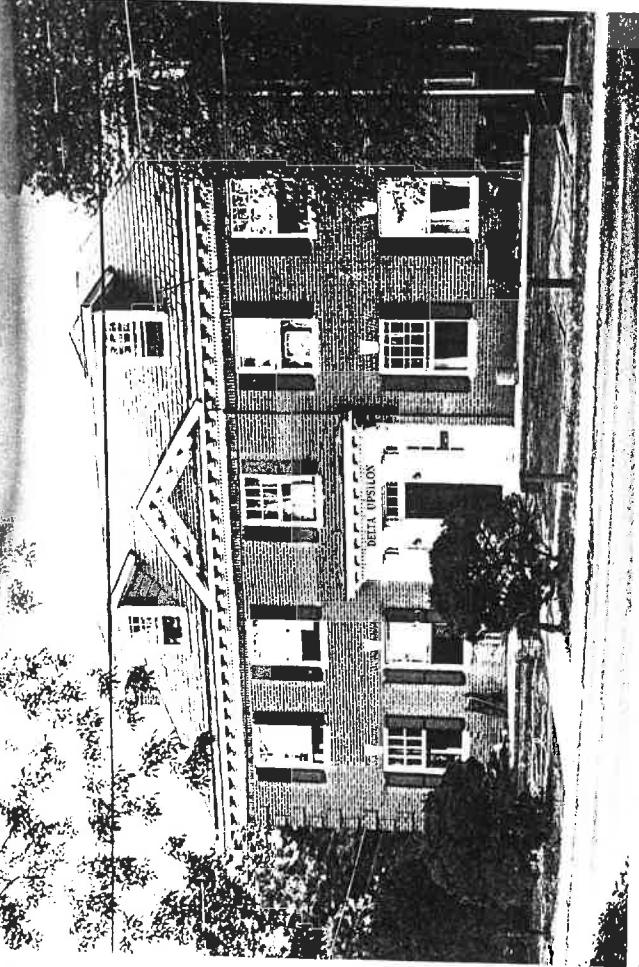

Miscellaneous descriptive information (plan, exterior and interior decoration, cornice/eave type, window type and trim, chimneys, additions, alterations)

This is one of the few fraternity houses of its period in Charlottesville without a porch or portico. Following traditional Virginia Georgian forms, it has a prominent modillion wood cornice, a Classical door frame, and good-quality brickwork in Flemish bond with jack arches at the windows. The small decorative front pediment enlivens the facade.

Historical information

The last UVa fraternity house to be erected south of the railroad tracks, the Beta house was built for the Beta Theta Pi fraternity house, which occupied it until the local chapter became inactive in 1972. The local chapter of Delta Upsilon has occupied it since 1973.

The Beta house gave its name to nearby "Beta Bridge", just northwest.

Source City directories; Eugenia Bibb; T. Bishop, "Fraternities at UVA..."
 Surveyed by Jeff O'Dell, VHLC Date 9-83



Date 3/9/90 File No. 104-133-10

Name Delta Upsilon, 180 Rugby Rd.

Town Charlottesville

County _____

Photographer S.E. Smead

Contents 4 exterior views

