

Property Information

Property Names

Name Explanation	Name
Function/Location	House, 206 10th Street NW

Property Evaluation Status

Property Addresses

Current - 206 10th Street NW

County/Independent City(s):	Charlottesville (Ind. City)
Incorporated Town(s):	No Data
Zip Code(s):	22903
Magisterial District(s):	No Data
Tax Parcel(s):	No Data
USGS Quad(s):	CHARLOTTESVILLE EAST

Additional Property Information

Architecture Setting: Urban

Acreage: No Data

Site Description:

January 2020: This two-and-a-half-story dwelling is located on the east side of 10th Street NW. The northwest side of the property has a concrete and fieldstone retaining wall along the street. The property slopes downhill towards the northwest. This property consists of a house.

Surveyor Assessment:

January 2020: This property was built in 1922 according to the City of Charlottesville Property Records and owned by John G. Tonsler, Jr. and his wife, Stella R. Tonsler, as of 1964 (City of Charlottesville GIS Viewer 2020). This house first appears on the 1929 Sanborn Map, and the footprint has not changed (Sanborn Map Company 1929; Sanborn Map Company 1950).

This dwelling retains excellent integrity of location and setting. The integrity of design, materials, and workmanship has been compromised by replacement windows. The dwelling retains good integrity of feeling and association. Overall, this property retains good integrity.

This property is recommended not individually eligible for listing in the NRHP due to a lack of historical significance. Further research is recommended to determine if this property represents the work of a master. Additionally, the property is located in the potential 10th & Page Historic District, which is recommended as potentially eligible for listing in the NRHP. Further study is recommended to determine if the 10th & Page Historic District is eligible for listing in the NRHP under Criterion A in the areas of Ethnic Heritage, Community Planning and Development, and Social History, and under Criterion C in the area of Architecture. This property includes one contributing primary resource.

Surveyor Recommendation: Recommended Not Eligible

Ownership

Ownership Category	Ownership Entity
Private	No Data

Primary Resource Information

Resource Category:	Domestic
Resource Type:	Single Dwelling
NR Resource Type:	Building
Date of Construction:	1922
Date Source:	Local Records
Historic Time Period:	World War I to World War II (1917 - 1945)
Historic Context(s):	Domestic
Other ID Number:	No Data
Architectural Style:	Vernacular
Form:	No Data
Number of Stories:	2.5

Condition: Good
Threats to Resource: None Known

Architectural Description:

January 2020: This two-and-a-half-story house is clad in red stretcher-bond brick and has a hipped roof covered with asphalt shingles. There is a brick chimney on the south roof slope. On the northwest-facing facade, there is a one-story, almost full-width, open porch with a hipped roof. It has a wood floor and wood Doric columns. The porch is accessed by concrete steps in the north end and has a wood railing in the south half. Also, on the facade, there is a front gable roof dormer clad in vertical vinyl siding. The fenestration openings are slightly arched. There is a one-story wing on the southeast elevation with a hipped roof covered in asphalt shingles. Visible fenestration consists of one-over-one, double-hung vinyl windows; and a single-leaf wood door with a single light and sidelight.

Exterior Components

Component	Component Type	Material	Material Treatment
Chimneys	Interior Slope	Brick	Stretcher Bond
Dormer	Gable	Vinyl	No Data
Foundation	Not Visible	No Data	No Data
Porch	1-Story Full-Width	Wood	Doric
Structural System and Exterior Treatment	Masonry	Brick	American/Common Bond
Windows	Double-hung	Vinyl	No Data
Roof	Hipped	Asphalt	No Data

Secondary Resource Information

Historic District Information

Historic District Name: No Data
Local Historic District Name: No Data
Historic District Significance: No Data

CRM Events

Event Type: Survey:Phase I/Reconnaissance

Project Review File Number: No Data
Investigator: Erin Que
Organization/Company: The 106 Group Ltd.
Photographic Media: Digital
Survey Date: 2/5/2020
Dhr Library Report Number: No Data

Project Staff/Notes:

Erin Que, Principal Investigator and Sr. Architectural Historian
 Holly Good, Architectural Historian
 Saleh Miller, Sr. Architectural Historian

Project Bibliographic Information:

City of Charlottesville GIS Viewer
 2020 Property Record. Electronic document, <http://gisweb.charlottesville.org/GisViewer/>, accessed January 27, 2020.

Hill Directory Co.
 1931, 1940, 1950, 1959 Hill's Charlottesville City Directory. Hill Directory Co., Inc., Publishers, Richmond, Virginia.

National Environmental Title Research, LLC [NETR]
 1963-2016 Historical Aerial Photograph, Charlottesville Independent City, Virginia. Electronic document, <http://historicaerials.com/>, accessed March 19, 2020.

Neighborhood Development Services
 2012-2016 The 10th and Page Historic Survey. On file at the City of Charlottesville Neighborhood Development Services, Charlottesville, Virginia.

Sanborn Map Company

1907, 1913, 1920, 1929, 1950 Fire Insurance Map of Charlottesville, Virginia. Sanborn Map Company, New York, New York.

United States Geological Survey [USGS]
1994-2019 Historical Aerial Photograph, Charlottesville Independent City, Virginia. Electronic document, accessed on Google Earth, February 20, 2020.

Bibliographic Information

Bibliography:

Cross-White, Agnes
1998 Images of America: Charlottesville, an African-American Community. Arcadia Publishing, Charleston, South Carolina.

Property Notes:

No Data

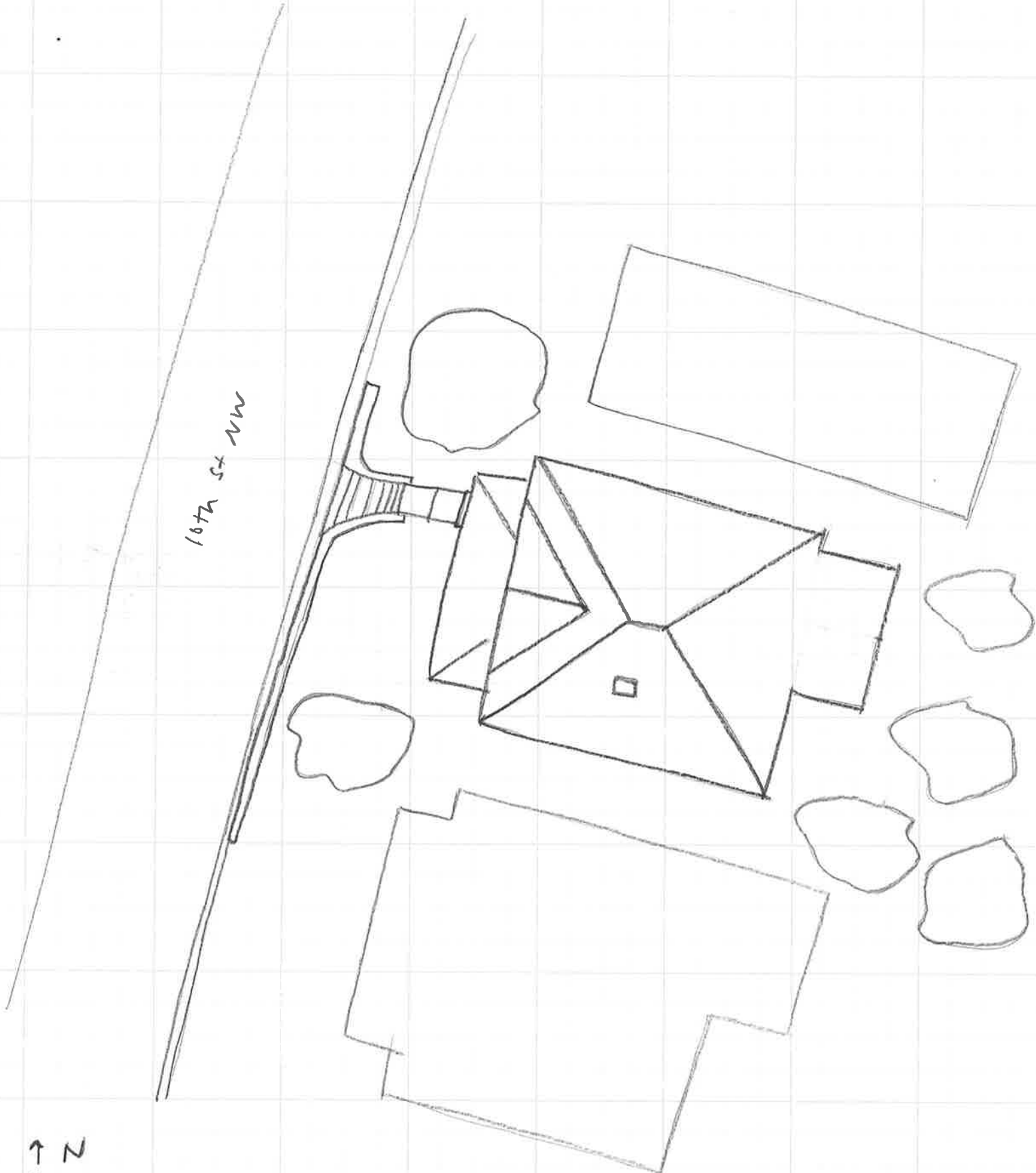

10th St NW

↑ N
House
104-5624
206 10th St NW
Survey Date: 1/30/20
Not to Scale